

CHECK LIST

This kit should contain the following:

- 1 x SHEET A. Printed kit parts.
- 1 x SHEET B. Printed kit parts.
- 1 x SHEET C. Laser cut window frames.
- 1 x RED CARD. Laser cut doors.
- 2 x GREY CARD. Inner Supports.
- 1 x GLAZING sheet.
- 1 x INSTRUCTION BOOKLET.
- 1 x RIDGE TILE SHEET

READ THROUGH ALL THE INSTRUCTIONS BEFORE YOU START.

This is a complex kit that requires particular attention to detail, so proceed with care!

To construct this kit you will need the following:

1. A modellers knife.
2. A pair of sharp scissors.
3. A steel ruler.
4. Glue - See glues.
5. Ultra Fine Tip Glue Applicator, see below.
6. A cutting surface - a sheet of card or cutting mat.
7. Fine point tweezers.

METCALFE

Ultra Fine Glue Tip Bottles.

These bottles are essential for gluing the smaller components in this kit.

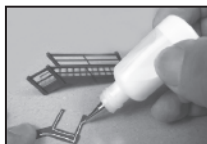

Tiny strips and spots of glue can be accurately laid down with precision.



GLUES

UHU Solvent Free All Purpose Adhesive Glue

Works superbly well in our fine glue applicators. Dries quickly, but allows time for positioning of kit parts as described further on in the instructions.

Also **Deluxe Materials 'SPEEDBOND'**

A fast drying PVA.

see: www.deluxematerials.com

GETTING STARTED

1 EXTRACTING COMPONENTS FROM THE BASE SHEETS.

To stop the components from falling off the sheets, they are held secure with score lines. These are cuts that only go about 75% of the way through the card.

To release them run the point of your knife along these score lines and they will come seamlessly away.

These score lines are marked with blue arrows: **WARNING**, Cut with care using a knife that is not too sharp, this will reduce the risk of the blade running off the score and cutting the components.

2 PRE-BUILD PREPARATION

Before you go any further it is best to paint the white card that shows on the corners and edges **NOW** before any building work.

All you need is a simple set of water colour paints and a fine brush.

We use these Rowney paints and the lid is used for mixing the colours.



Mix your colour with lots and lots of water, approx. 1 part paint to 5 parts water or more. **TEST ON WASTE CARD FIRST UNTIL YOU HAVE THE CORRECT SHADE & COLOUR.**

To match the brick colour you will only need to mix a warm red and equal amounts of brown along with lots of water. You don't want to be painting a solid line of colour, you only need to tint the card a little.

Fold corners fully back then run the brush along the score and let the watery tint soak into the card.

Wipe away any excess paint off the printed surface before it dries.

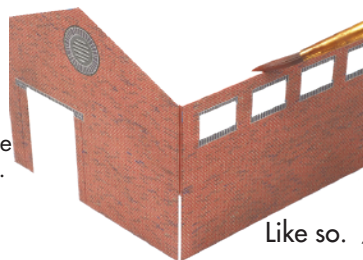

Like so.

Paint all the red brick edges and fold lines as you extract them from the sheet.
Keep the components separate from your working area by placing them on a tray or thick piece of card that we'll affectionally call the 'builder's yard'.



3 WINDOWS

Cut out all the clear glazing components (windows) and place on a separate sheet of dark card so they don't get lost. Also add the components from the red laser cut sheet and Sheet C which contains the window frames.

Now match the glazing to the corresponding window and door frames. Carefully align and glue each glazing to the back of the matching frame with the matt white printed side facing through the openings.

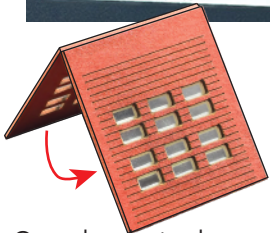

Once the glazing has set on the garage door fold in half and glue into 2 place.

Choose between the white or red door for the office front and glue into place to the back of the office front frame, once the glazing has set in place.

The printed office doors have a brown 'band' across the top.

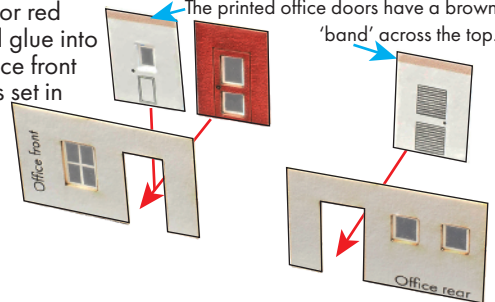

The tower doors have a green 'band' across the top, carefully align them to the corresponding Tower door and rear frames.

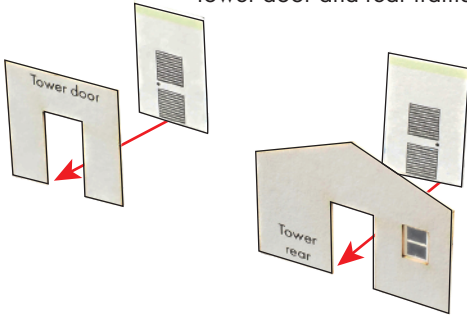

Once all the windows and doors have been paired with their frames place them back into the builders yard until they are needed.

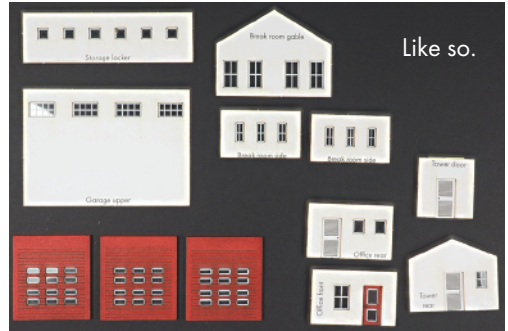

4 STRENGTHENERS

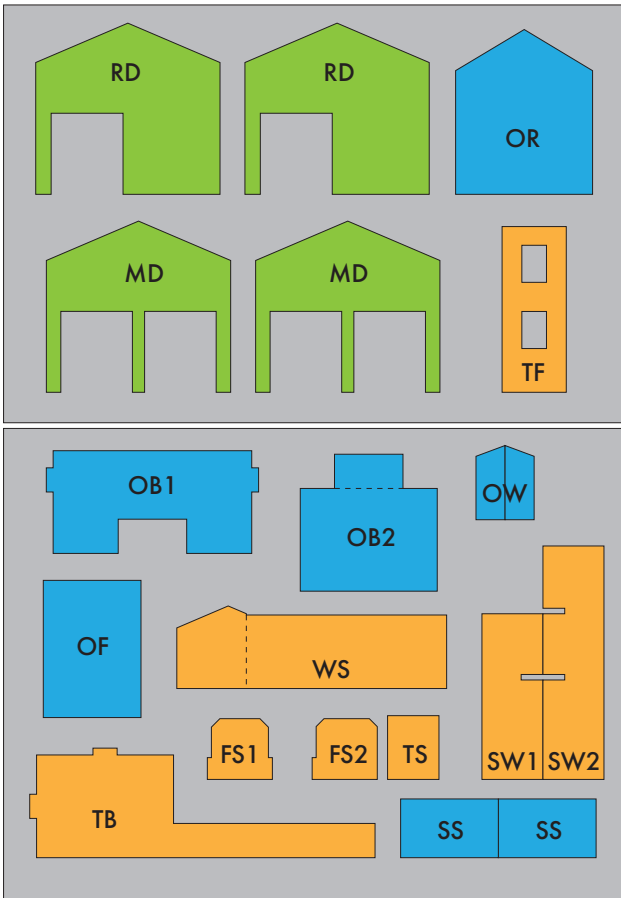

Strengtheners Key

The opposite diagram identifies the inner strengthening components for this kit.

The **green** components are required for the garage build - Fig 5

RD - Rear door x 2
MD - Main door x 2

The **orange** components are required for the tower and side storage build - Fig 6

TF - Tower front
SW1 - Side wall 1 (short)
SW2 - Side wall 2 (tall)
FS1 - Floor support 1 (lower)
FS2 - Floor support 2 (upper)
TS - Tower spacer
WS - Wall support
TB - Tower base

The **blue** components are required for the office block - Fig 7

OB1 - Office base lower
OB2 - Office base upper
SS - Side supports x 2
OF - Office floor support
OW - Front & rear office side walls
OR - Office rear wall

5 GARAGE

Start by combining the printed rear door inner wall with the two matching grey strengtheners (RD) to create a wall three layers thick, keeping all the edges flush.

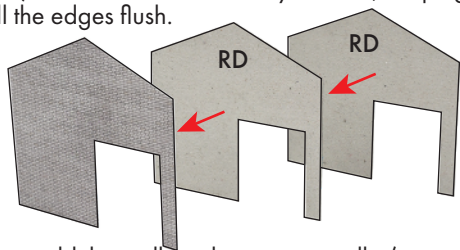

Then do the same with the main door inner wall and the two main door strengtheners. (MD)

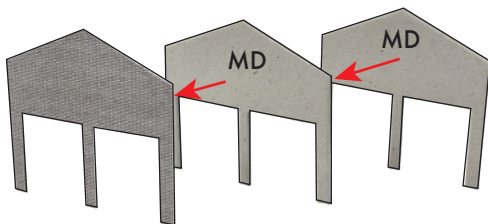

Now add the walls to the garage walls, (grey strengthener card to the back of the outer walls) again keeping the top and bottom edges flush.

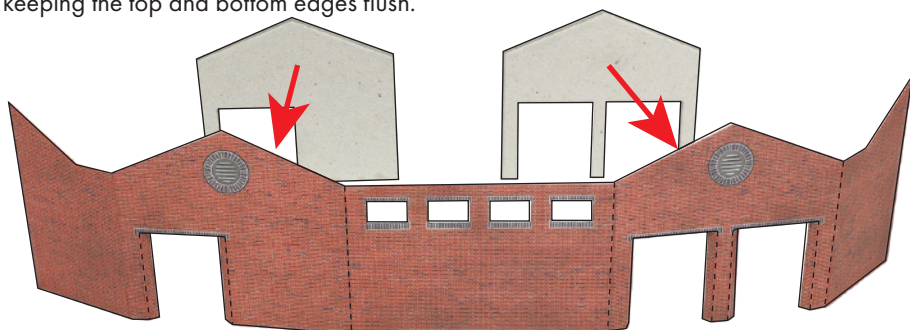

Reverse view

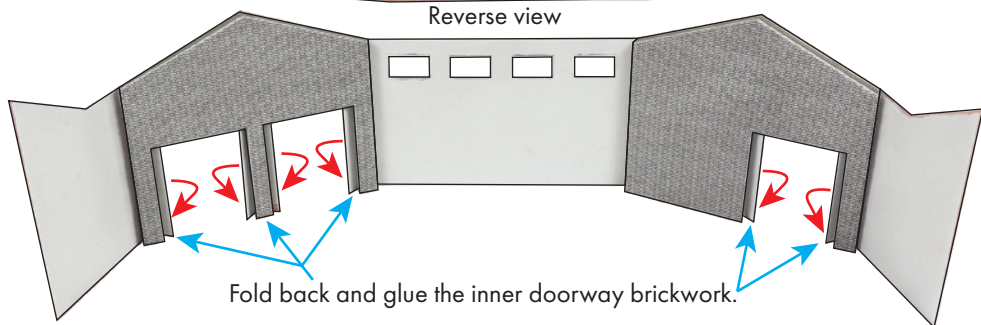

Fold back and glue the inner doorway brickwork.

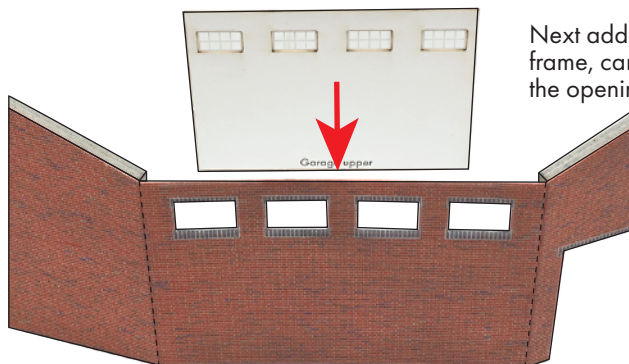

Next add the Garage upper window frame, carefully aligning the windows to the openings on the garage walls.

Then add the Garage window side inner wall again carefully aligning the windows to the openings, and keeping the top and bottom edges flush.

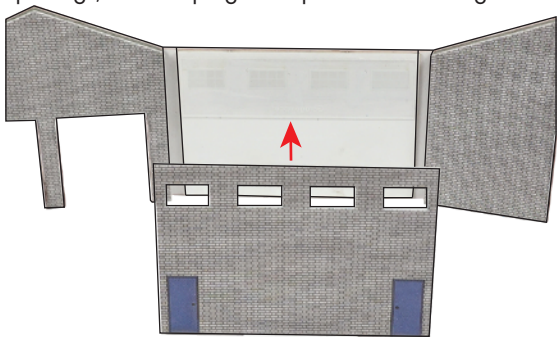

Finally add the garage adjoining inner wall, this acts a brace that joins the two halves of the outer wall together. Keep the bottom edges flush and glue into place.

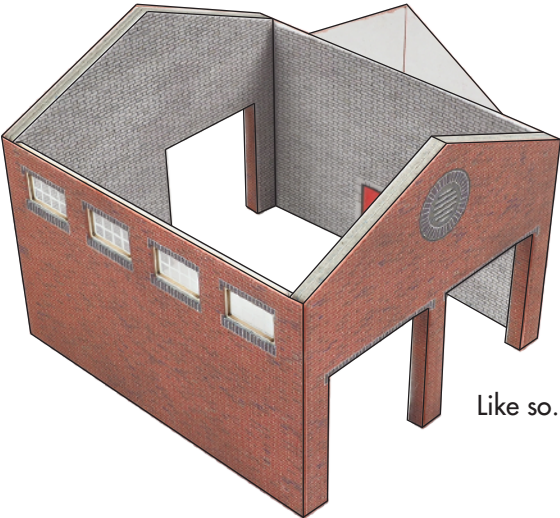
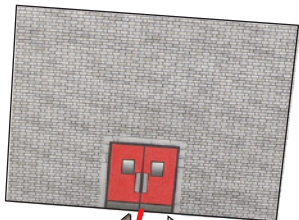

Like so.

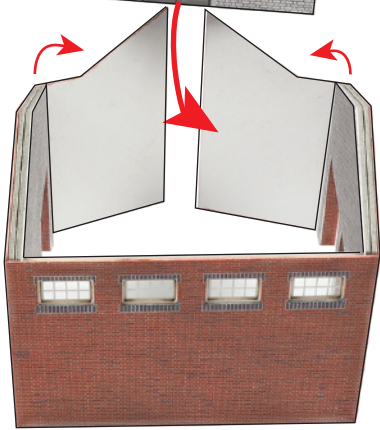

6 TOWER & SIDE STORAGE BUILDING

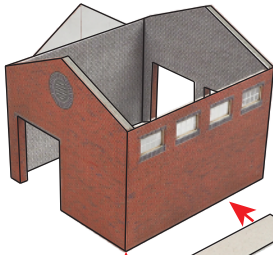

Start by adding the grey tower base from the strengthener sheet (TB), this butts flush against the garage walls, add small spots of glue along the edge and fix to the garage.

Then add the wall support (WS). This fits flush to the garage walls and on top of the base.

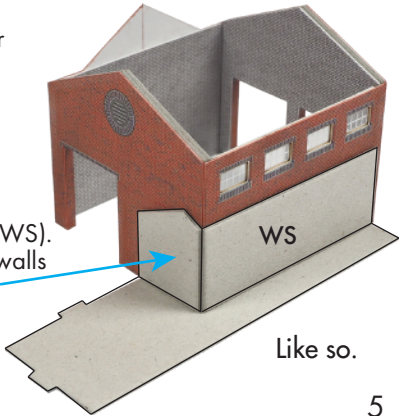

Like so.

Next carefully glue into position the storage locker window frame, align with the openings on the side storage walls, NOTE that the inner frame's bottom edge will be at least 1 mm higher than the outer wall. This is to allow the frame to rest atop the base card.

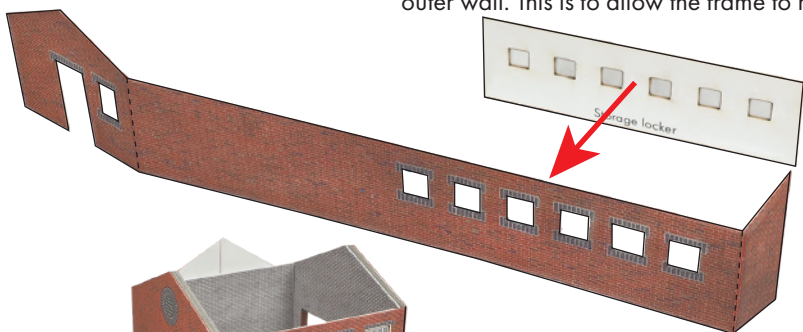

Test this fit before applying glue. The side wall wraps around the edge of the base with the doorway straddling the doorstep. The opposite slanted end wall fitting flush against the grey wall support

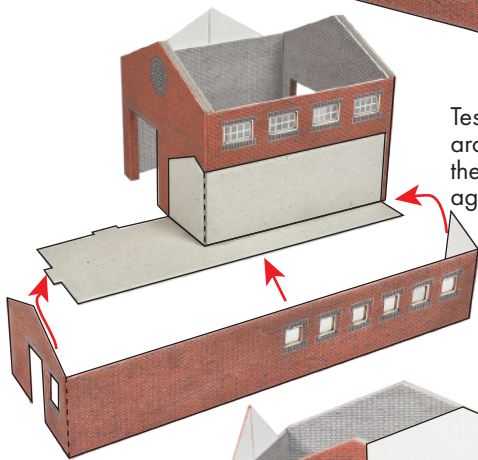

Like so.

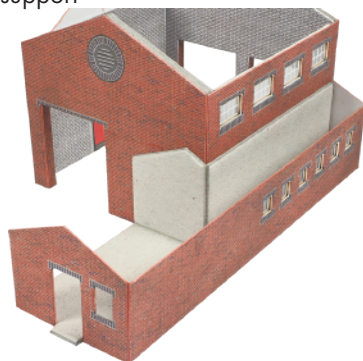

Then add the tower door and window frame into place flush against the back of the door opening.



Now onto the tower, first add the two side wall grey strengtheners.

The taller one (SW2) with the two slots fits tight into the fold corner on the tower rear and side wall. (on the wall without a window opening)

The shorter strengthener (SW1) fits on the opposite wall again tight into the fold. Leaving a 1 mm gap along the rear wall edge.

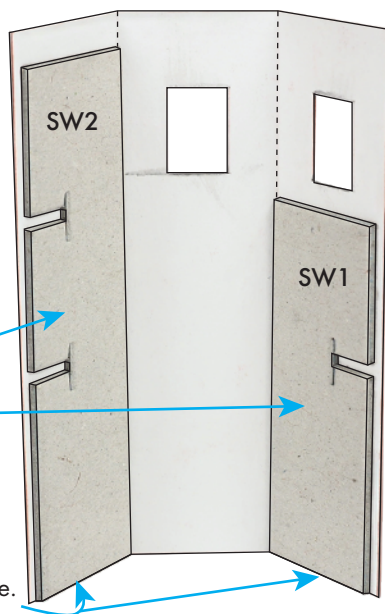

Keep flush to the bottom edge.

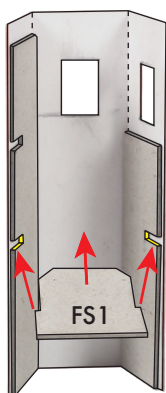

Slot the floor support (FS1) into place, with the wings fitting into the lower slots on the side wall strengtheners (marked yellow above). Keep the back edges all flush.

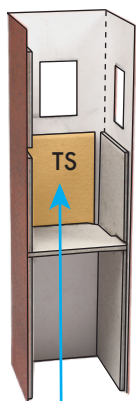

Then position the tower spacer (TS - coloured orange above) against the back wall keeping the top edge level with the smaller side wall strengthener (SW1).

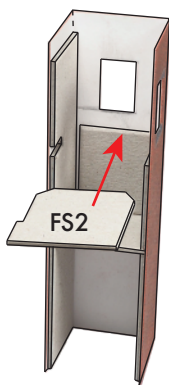

Now add the floor support (FS2), have the wing fit into the side wall slot and resting on top of the opposite wall strengthener and back wall strengthener.

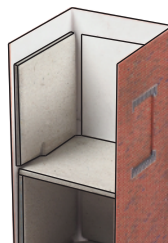
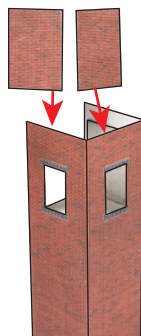

Like so.

Lastly add the Tower 'bricked up' windows to the 2 openings. Keeping the top edges flush with the taller side wall strengthener.

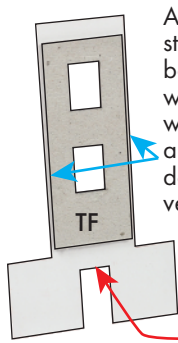

Add the tower front strengthener (TF) to the back of the Tower front wall, keeping the window openings flush and a 1mm space down each of the vertical sides.



Carefully align the tower door flush against the base of the strengthener keeping a 1mm gap along the bottom edge of the tower front wall.

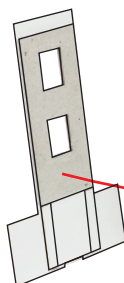

Test this fit before applying glue. Add the front wall to the rest of the tower. The side walls fit flush to the front wall and into the 1mm vertical gap that runs down the side of the strengthener and door. Keep the top edges flush, letting the front wall bottom edge drop 1mm below the rest of the tower.

'Upside down view'
Note the 1mm overhang at the base of the tower.

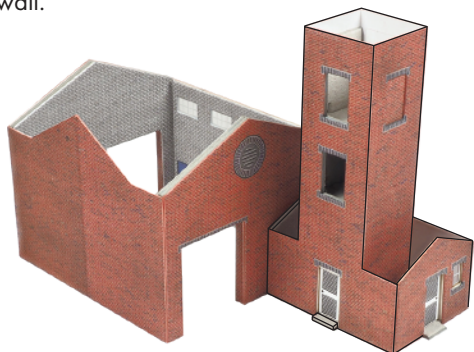

Now add the completed tower to the rest of the model. The tower 'wing' walls fit flush against the wall support and the tower rear door wall with the tower walls overhanging the main base.

Drop in the tower roof, this sits flush against the top of the strengthener and the two 'bricked up' windows.

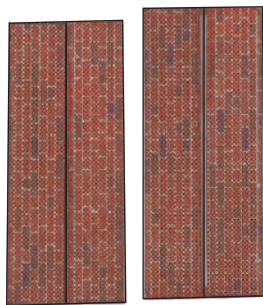
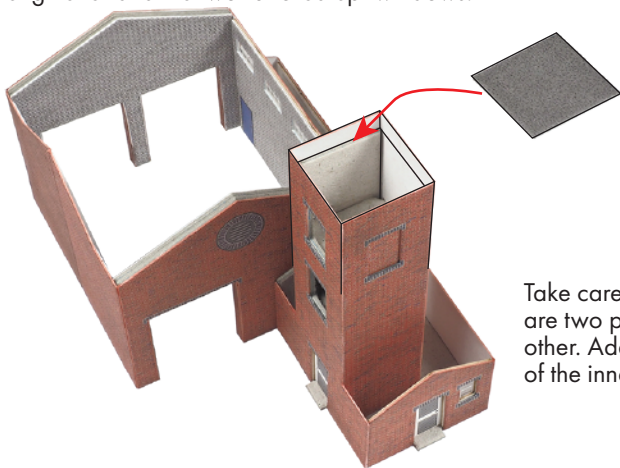

Take careful note of the tower inner walls, there are two pairs, one pair slightly longer than the other. Add the longer pair first at opposite sides of the inner walls keeping the top edges flush.

Then add the shorter inner walls to the other two sides.

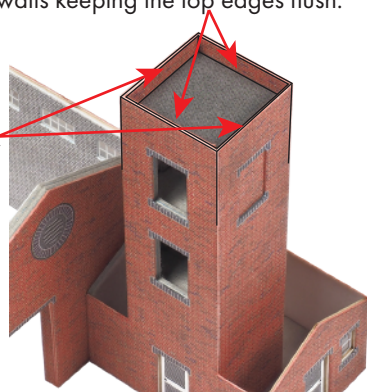

Now add the tower capping stones



Lastly add the side storage roof, test the fit first before adding glue it is a tight fit around the tower.

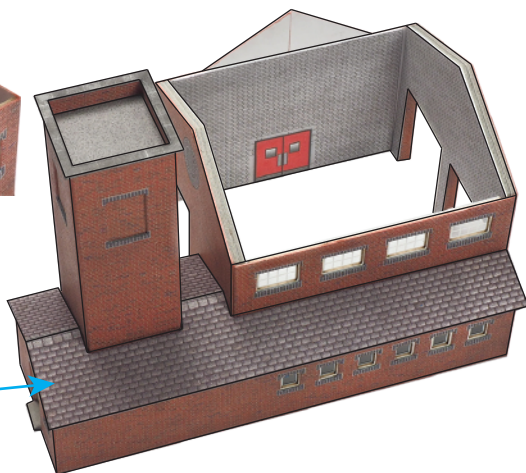

7 OFFICE BUILDING

Start by combining the two base strengtheners OB1, & OB2. Fold back and glue the position tab on OB2 then affix to OB1 - the tab fitting into the slot, centralising the base card.

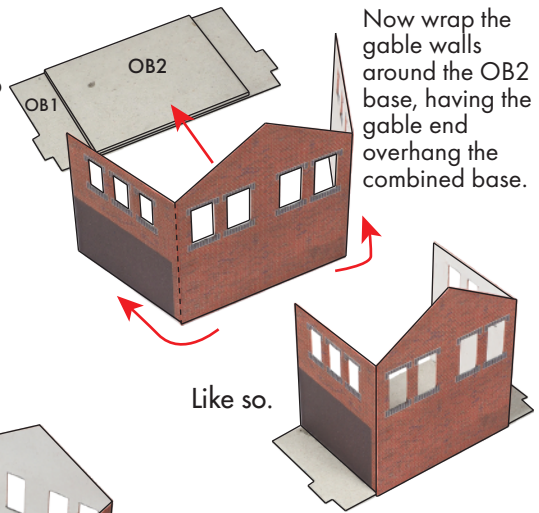
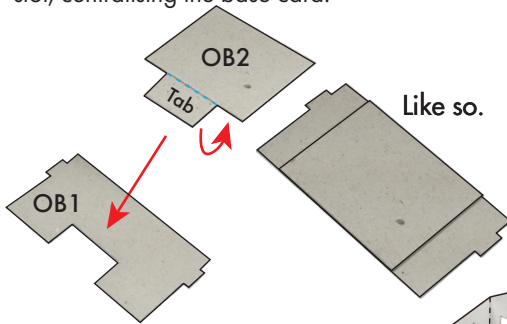

Add the two side supports (SS) flush to the base and tight into the corner fold of the gable walls, this will leave a 1mm gap at the back edge of the support to the back edge of the gable wall.

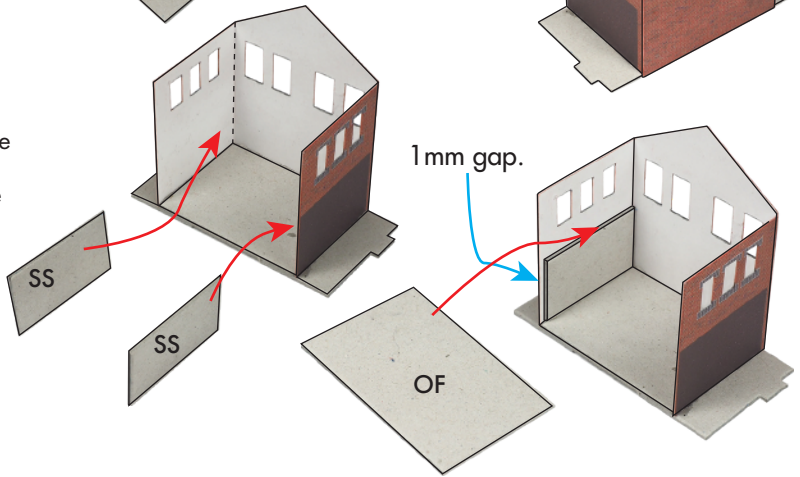

Then add the office floor support (OF) resting it atop the side supports and flush to the inside of the gable wall again leaving a 1mm gap at the rear.

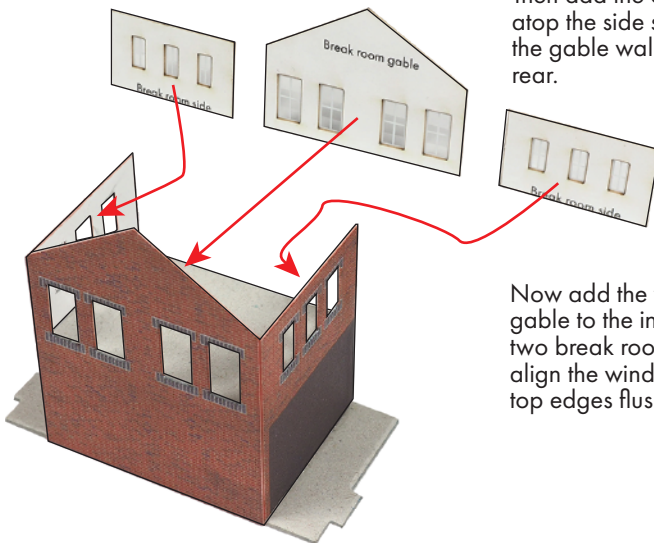

Now add the window frames, Break room gable to the inside of the gable wall and the two break room sides to either side. Carefully align the windows to the openings keeping the top edges flush with the outer walls.

Now add the office rear wall (OR), this slots into the 1 mm gap and sits on the base and flush against the inner supports and flush with the back of the main gable walls.

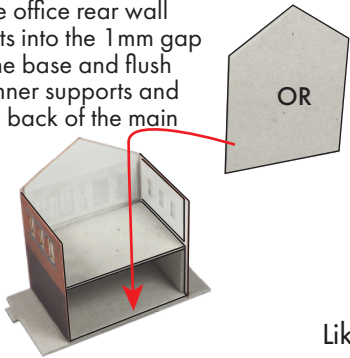

Like so.



Add the complete office block to the side of the garage. Carefully centre the building and keep the apex edges flush.

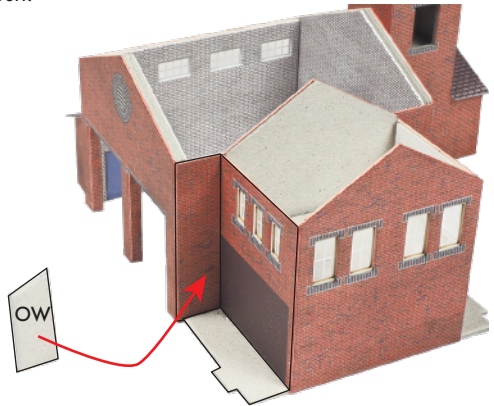
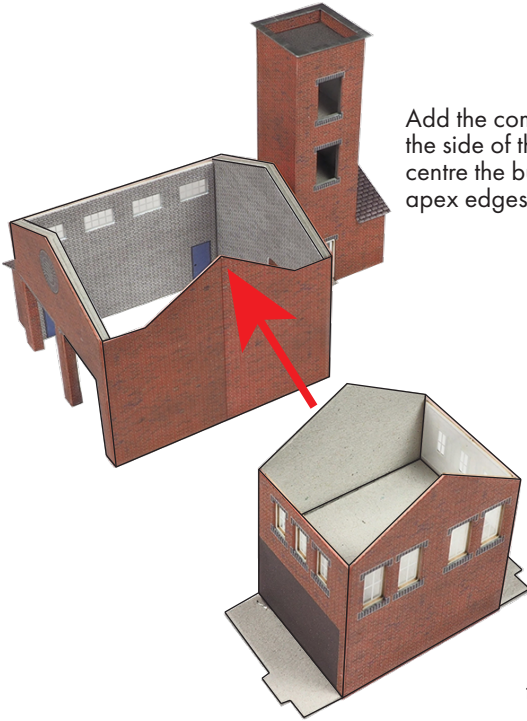

Now add one of the front/rear office side walls (OW) to either side of the office and glue flush into the corner against the garage wall.

Add the office front and rear frames to the corresponding walls carefully aligning the windows to the openings keeping a 1 mm space from the bottom of the wall to the bottom of the frame, so that the doors will sit on top on the doorstep on the base.

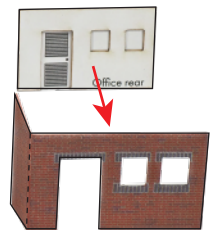
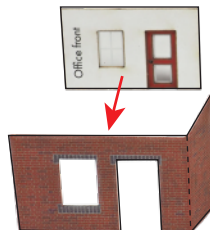

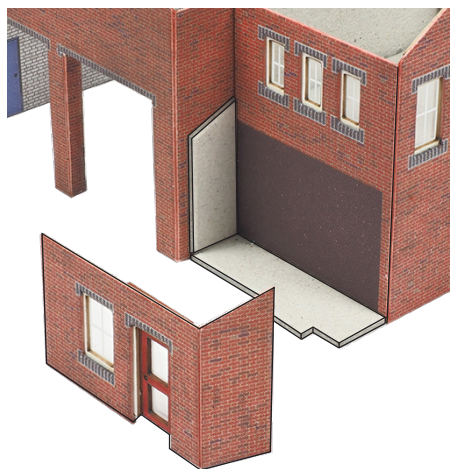

Attach the front/rear office walls into place, these fit flush to the office base with the door step fitting below the doorways. The side wall folds round and fits flush into the corner fold of the gable end.



Like so.



Then add the small side roof.

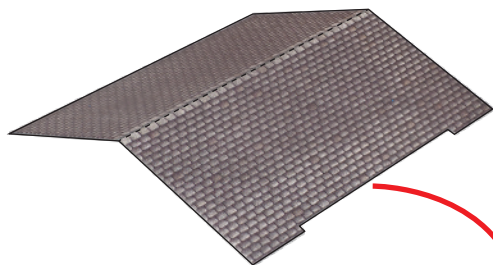

Now the main roofs. First add the garage roof, the cut out section on one side fits against the gable end, test the fit then glue into place.

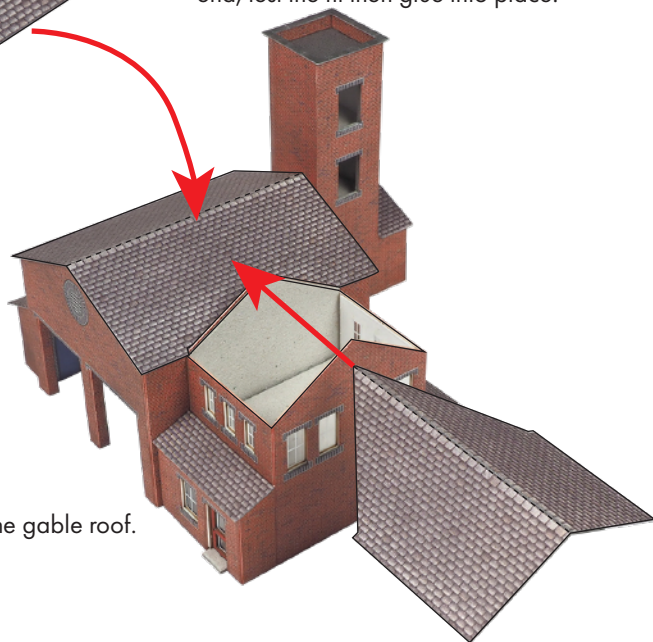

Then add the gable roof.

7 FINISHING TOUCHES

