

**Contents.** The kit comprises SHEET 1 & SHEET 2, the illustrated SUPERQUICK header card, ACCESSORIES CARD, an acrylic glazing sheet, this ASSEMBLY INSTRUCTIONS sheet and a CUSTOMER REPORT card.

**Tools.** A sharp modelling knife and a steel rule are essential. Bulldog clips, a few rubber bands and 'Sellotape' might be useful to secure parts of the kit while glue is drying.

**Glues.** Most liquid glues are suitable. PVA glue is recommended, it becomes matte and almost transparent when dry, although in cold conditions the glue tends to dry white. A solvent glue like 'Evostick' or 'UHU' is also recommended as it is quick to dry but can present problems when touching up model with water based paint.

For gluing areas of paper, such as lining pieces, it is recommended that PVA be thinned or that a spray or a spreadable solvent glue is used.

**Card-mounted components.** Separate the parts only when called for by nicking with the knife at uncut points.

**Scoring.** Red arrows signal a fold back. Blue arrows signal a fold forward. Where the cutter lines are marked with arrows they are scored (i.e. only partly cut through). Here the component is intended to be bent or folded.

Sometimes additional scoring with the knife may be necessary, so that the board bends at the fold line without too much resistance. If the fold line is cut through, a

repair can be made by gluing a thin paper strip to the back.

When folding a piece forward on a perforated cut it is important to score lightly along the perforation on the reverse of the card.

**Waste.** Waste card is kept to a minimum & is indicated by the symbol

**Windows.** The Glazing Sheet has 13 window pieces divided by dotted lines. There are two methods of glazing, which can be combined for a really durable result:

(1) Lay down the window piece face up. Apply glue to the back of the wall around the window aperture and the lower the wall onto the window piece. This method is easier for small windows and permits

adjustment - correct the alignment before the glue sets and wipe excess glue from the window surface with a damp paintbrush or tissue.

(2) Apply narrow strips of 'Sellotape' along two sides of the unprinted back of the window piece. Lay the window piece down as before and lower the wall onto the partly exposed 'Sellotape'. When the window is attached to the wall, rub down the tape and apply further strips to the remaining two sides of the window piece.

**Finishing.** The appearance of the completed model will be greatly improved if all exposed edges are touched up with paint. It is important that there is no glue on exposed edges.

## SECTION 1

1. Remove the four walls as one piece, including the bottom edge Tabs and the Tab at one end formed from the white margin, nothing the red arrow bending cuts. Also detach the Barge Boards for this Section, their Packaging, Corner Strengtheners 1, 2 and 3, Section 1 Wall Spacer and Doors 1a and 1b. Remove the two Dormer Windows 1a and 1b and their Roofs from the side wall and from inside the Paving. Remove all waste pieces from the window and door apertures, marking on the back beside each window aperture the red letter referring to the glazing piece and curtain to be used. If necessary, deepen the red arrow cuts as described above. Glue the Barge Board Packings in place coinciding exactly with the sloping edges (Fig. 1). Cut out the transparent windows A, B, C and one D (as shown on the Window Chart below) along the dotted lines. Glaze the windows by attaching small pieces of "Sellotape" to the top and bottom sides of a transparent window piece and placing the part on the table sticky side up. Hold the wall above it and position the aperture over it, holding the window down with a pencil inserted through the aperture. When positioned, press down, turn the wall over and attach stripes to the other two sides. For a neat outside appearance, avoid overlapping with the "Sellotape" the window frame printed on the glazing. Now apply the appropriate curtains, also with "Sellotape". For the best effect, cut away the black inside areas, extending

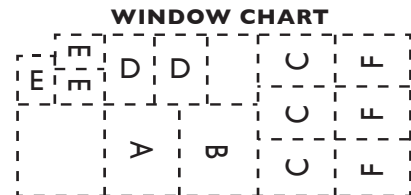
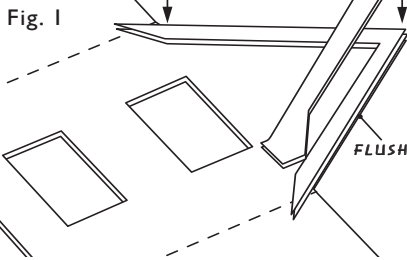

the top and bottom cuts to the four corners of the curtain. Each curtain can then be bent inwards slightly. The door and the lower half of the ground floor windows can be given a frosted glass appearance by attaching tissue paper behind before the curtains are added. Bend all the Tabs right back and glue down for double thickness. Fix the doors in place.

2. Bend up the walls noting how the corner point will be made by the edge of the back end wall overlapping the double thickness edge of the side wall, finishing flush on the outside (Fig. 2). Bend flat again and lay the left hand side wall on the table, printed side down, with the front wall raised at right angles to it. Glue Corner Strengtheners 1 into the corner, seated on the two Tabs marked 1. Repeat with the diagonally opposite corner marked 2. Add Corner Strengtheners 3 placed above 2 strut below the top edge of the side wall. When set, complete the corner point. Glue Wall Spacer 1 in place, set vertically about halfway between the end walls and no higher than the side walls.

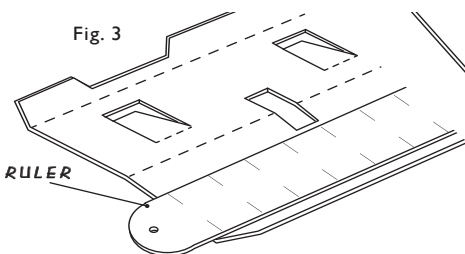
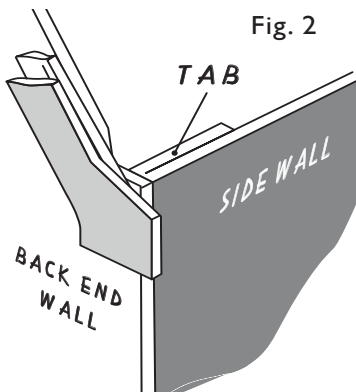

3. Detach Roof 1 noting particularly the blue arrow marked cuts and remove the Chimney aperture waste. Place a ruler on the main part of the roof along one of the two blue arrow marked cuts. Hold

down firmly and with a second rule or stiff knife, raise the remainder about 45 degrees (Fig. 3). Smooth out any surface creasing with the edge of the ruler and repeat along the other side. Bend the Dormer Window Curtains back and bend the roof along the Ridge Tiles. Glaze the Dormer Windows (Glazing E), bend to shape and glue them in place (Fig. 4) adding their Roofs. Cut off the card strip down the side of the kit along the black arrow marked dotted line and cut off the Gutters portion. Prepare the Gutters by first making light bending cuts along the red arrow marked dotted lines and bending right back along these lines before opening flat again and cutting out. Bend over and glue down for double thickness the two solid black sections leaving the Tabs to be bent at right angles and glued to the underside and edge of the roof (Fig. 5). It is better to attach the gutters before the roof is fixed in place, but with this model it can be done afterwards if preferred. The ends of the gutters extend a little beyond the end of the roof. Now fix the Roof noting that the Dormer Windows are positioned on the door side. This can be done wither in one operation or by gluing and fixing first one half and when secure, raising the other half to apply the glue.

Fig. 4

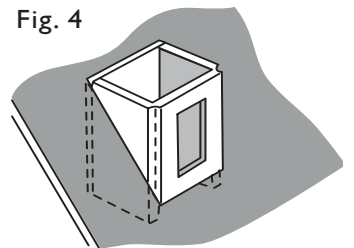
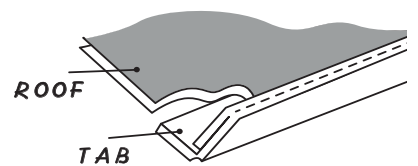

Fig. 5



## SECTION 2

Remove the Walls as before and glaze the window (F and D). Bend the blue tabs forward and glue down on the face to form a positioning set up for Section 3. Glue the Covering Piece (accessories card) over this area. Add Corner Strengtheners 4 and 5 as before. Make the corner joint and add the Wall Spacer 2. Detach Roof 2 noting the blue arrow cuts., remove the chimney waste piece, bend to shape and butt joint the hips by attaching on the underside half-inch wide strips of gummed tape or glued strips of thin paper. Add the Dormer Window and Gutters and press forward the inverted V cut shown. Set the Roof aside.

## SECTION 3

1. Remove the three walls, deal with the red arrow bending cuts. Glue down the Barge Board as before, glaze the window, glue down the Tabs and add the Nameboard and Inn Sign. Bend to shape and glue around the Floor which is seated on the Tabs, before glazing and fixing Door 3 and the Window Display. Insert into the cut out portion in the Paving, flush at the back edge. Add the Steps (glued double) and fix the whole to Section 2, the inside surface of the side walls fitting against the ends of the blue tabs (Fig. 6). Now attach Roof 2, positioning it flush with the left hand wall followed by Roof 3.

2. Make light bending cuts along the red arrow bending lines of the Chimney Stacks before cutting out. Glue to shape and add the Chimney Tops. Cut out the CHIMNEY POTS, dampen the white tapered portion and after a minute start from this end to roll it tightly between finger and thumb. Continue until it has become a solid roll. Glue down the edge and place a spot of glue in each end depression. Inset a blunt pencil into each end in turn and revolve it to spread the glue. This will harden the edge. Leave some time for thorough drying of the damp core and then cut each pot into tow with a rolling action of the knife. Glue the Stacks into their apertures and attach the Pots. Add the Ridge Tiles, trimming the ends at the hips on Roof 2 with scissors. Join the two buildings together.

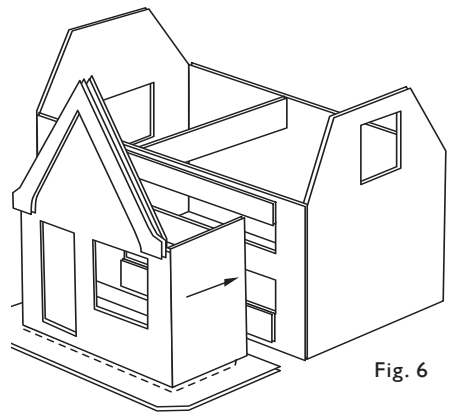

Fig. 6