

PO250 MANOR FARM HOUSE

SHEET 1

To construct this kit you will need the following:

1. A Modellers knife.
2. A pair of sharp pointed scissors.
3. A steel ruler.
4. Glue - UHU Clear Adhesive or Bostik Clear Adhesive are best. Make sure you get the tubes with the narrow nozzle for easy application.
5. A cutting surface - a sheet of card or a cutting mat.
6. Tweezers to hold the smaller components

READ THROUGH ALL THE INSTRUCTIONS BEFORE YOU START. This is complex kit that requires particular attention to the fine details.

Your Work Surface

Keep offcuts to one side.

A clean flat working area

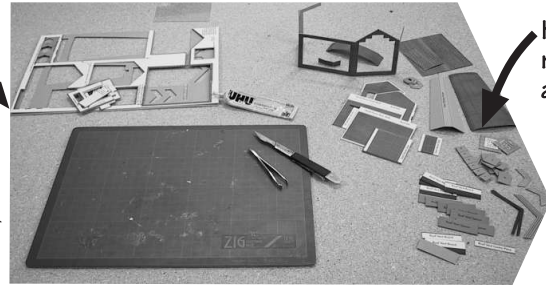

Kit bits ready for assembly.

Keep it tidy. When you have extracted components from the sheet, place them neatly to one side, FACE UP so you don't lose them. TAKE CARE WITH EXTRA SMALL COMPONENTS PLACE MULTIPLES IN PILES TOGETHER. DON'T THROW ANYTHING OUT. Offcuts can come in handy for bracing etc. and it also reduces the risk of accidentally throwing anything away.

Each component is fastened to the sheet by means of a score line. These are cut lines that have only gone about three quarters of the way through the card.

To detach each component from the sheet, locate the score line that is holding it in place

(these are clearly marked with blue arrows) and carefully run the point of your knife along the scoreline and the item will come seamlessly away. CAUTION - be very careful when running the point of your knife along these score lines. It is easy to run out of the groove and cut something you shouldn't.

Fig. 1. FARMHOUSE MAIN BUILDING OUTER WALLS.

Fold all the scorelines first to loosen them up, then place the main wall unit face down.

GLAZING.

Cut out each glazing window along the cut lines and place in piles outside your working area. All windows are marked with a brief description to guide where they go.

Fix each window to the openings with the matt printed side facing through the opening. Turn over and check to make sure each window is centered correctly.

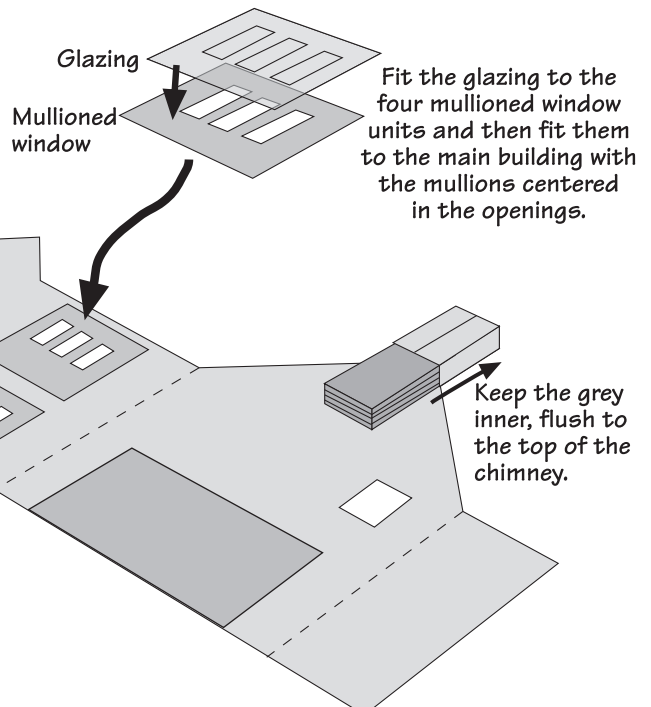

Chimney formers.

Fold chimney sides around.

Glue four of the grey chimney former cards together (located on grey sheet Fig.2.) then wrap the chimney side around it and fix with a spot of glue.

Fold over and glue the inner gable walls.

Fold the door sides over and glue to back of wall. Fix the door on to the tabs so it shows through the opening. Make sure it is flush along the bottom edges.

DOOR.

CHECK LIST This kit pack should contain the following:

- 1x SHEET A - Main farm house walls plus other bits.
- 1x SHEET B - Cottage walls plus roofs and other bits.
- 1x GREY SHEET - Contains inner floors and chimney formers.
- 1x GLAZING SHEET.
- 1x A3 INSTRUCTION SHEETS

Fig. 2. GREY CARD SHEET.

This sheet contains the inner floors and strengtheners.

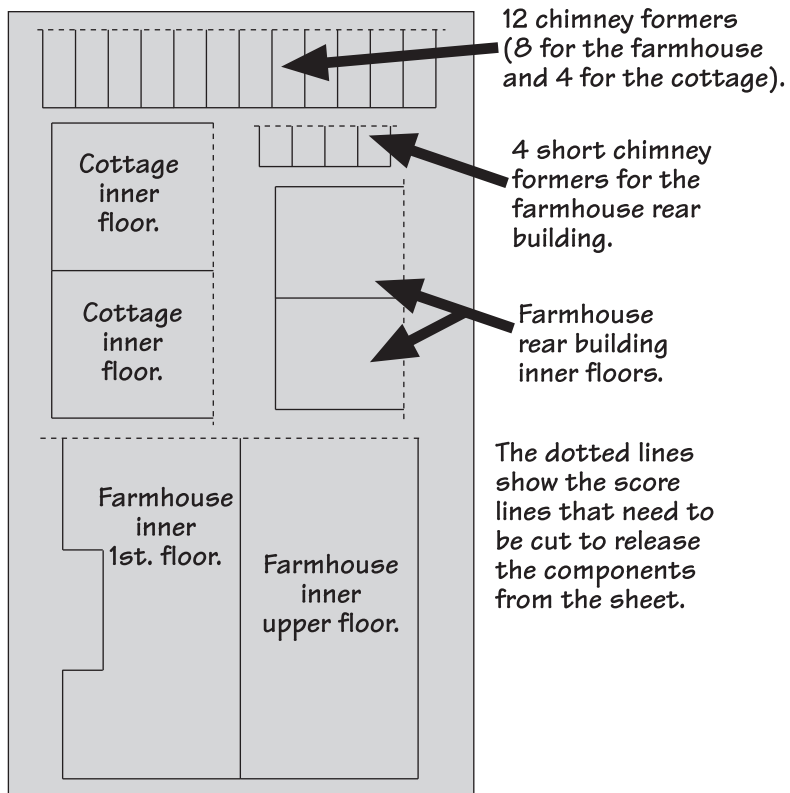

Fig. 3. FIT THE INNER FLOORS.

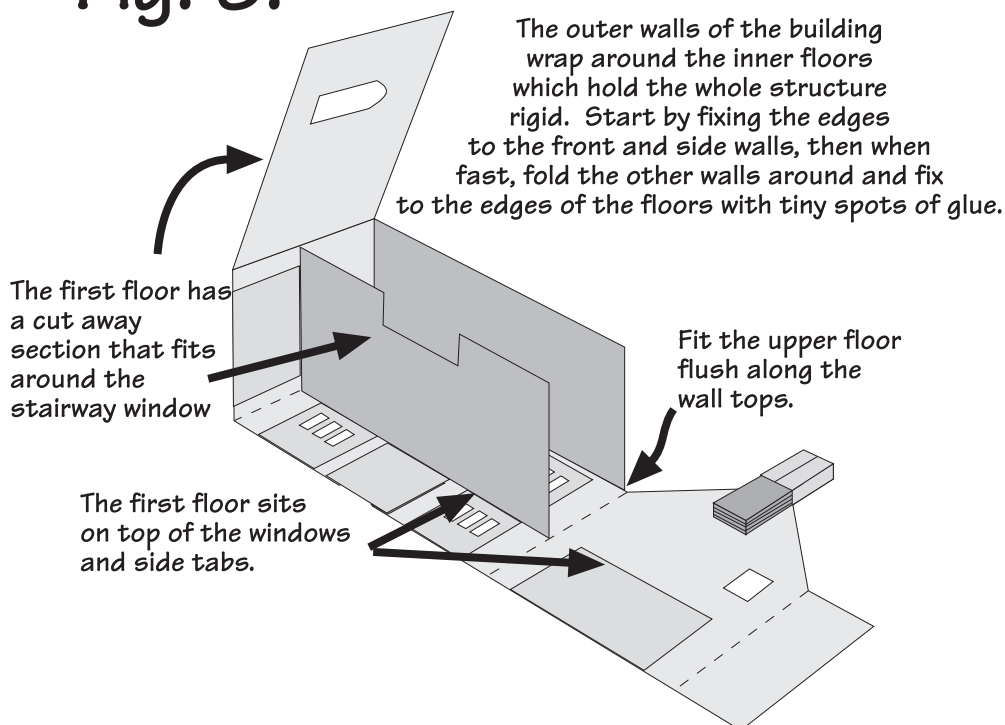

Fig. 4. FIT THE ROOF.

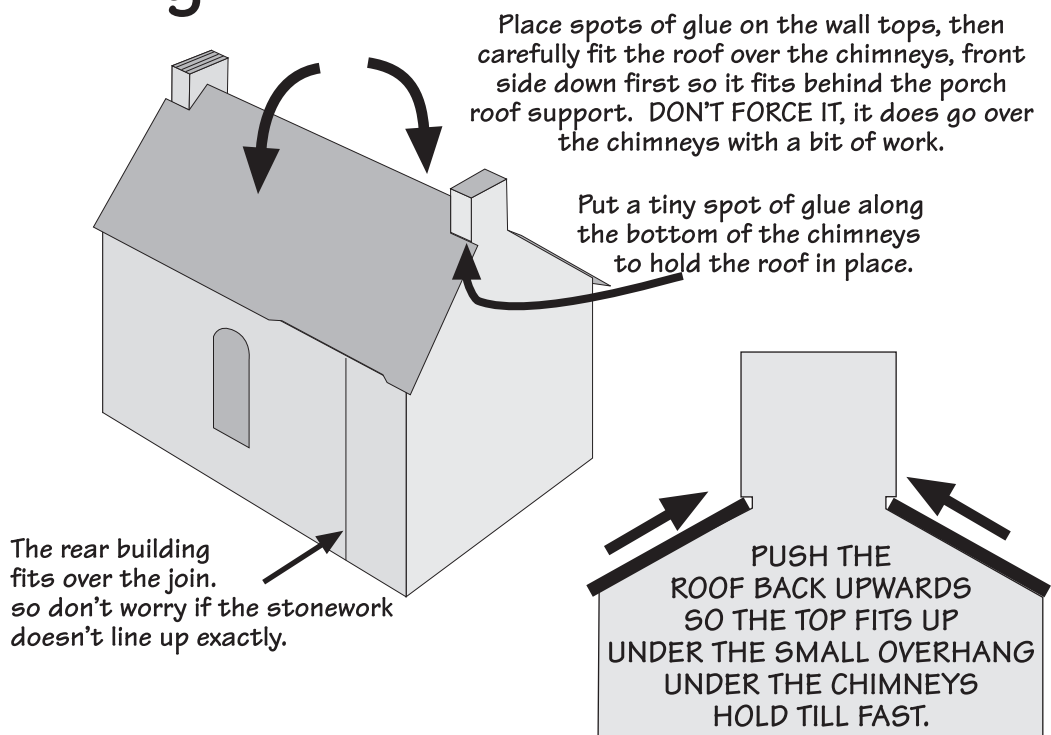

Fig. 5. FRONT PORCH.

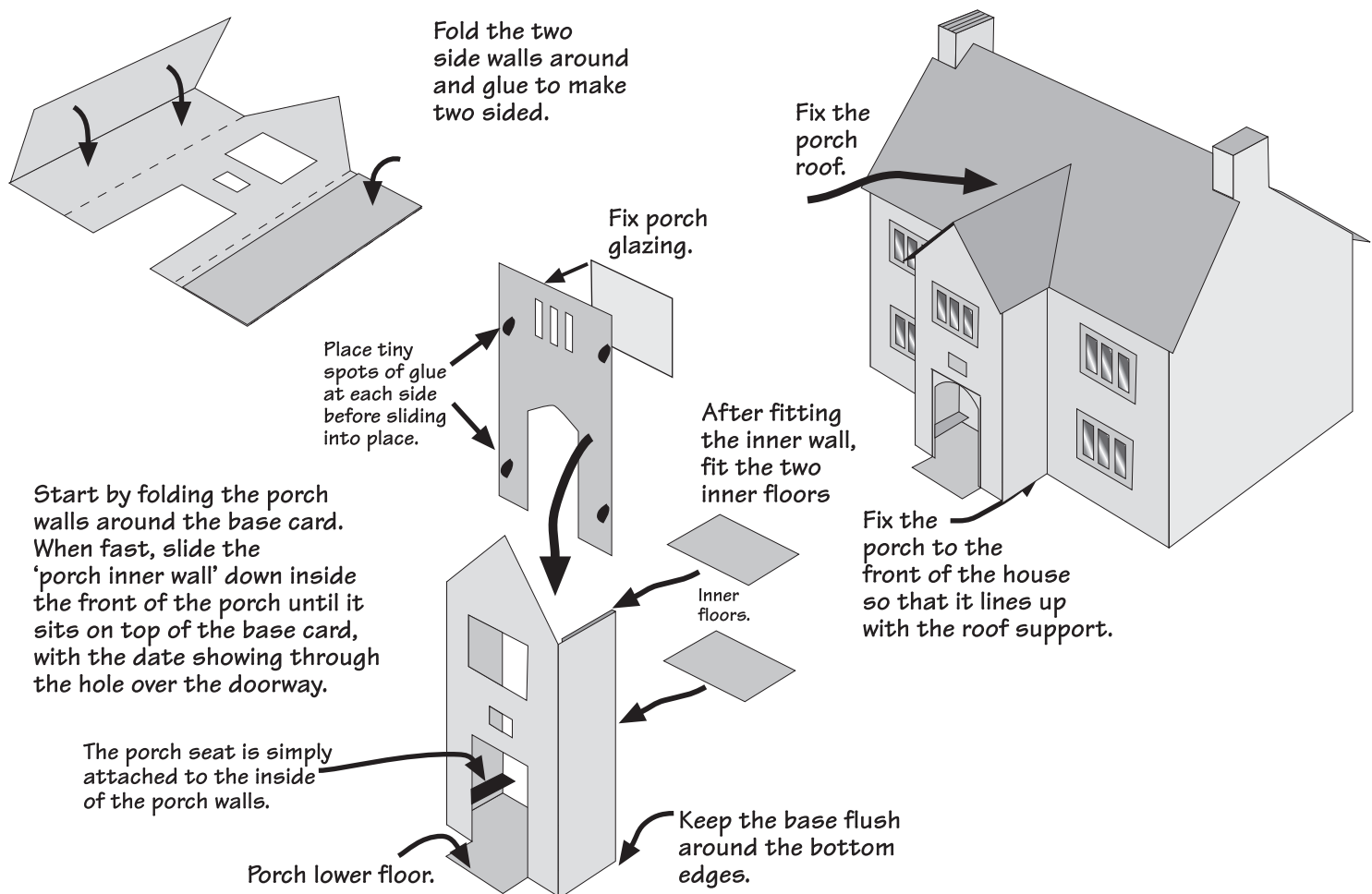
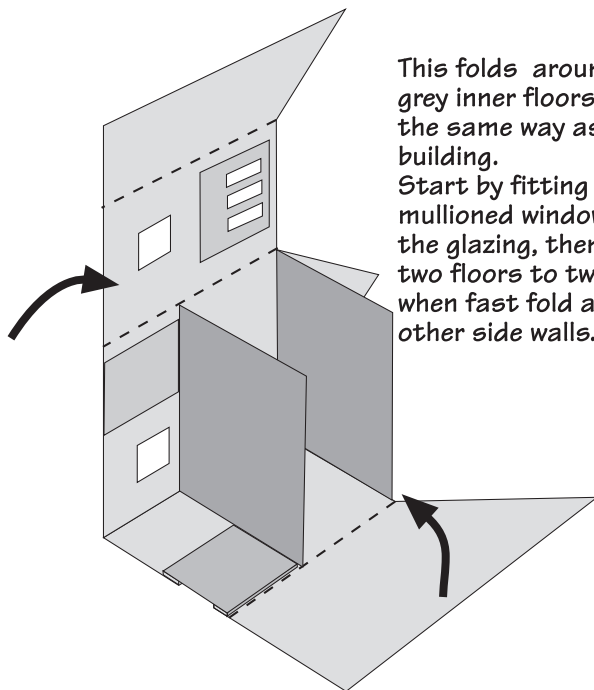
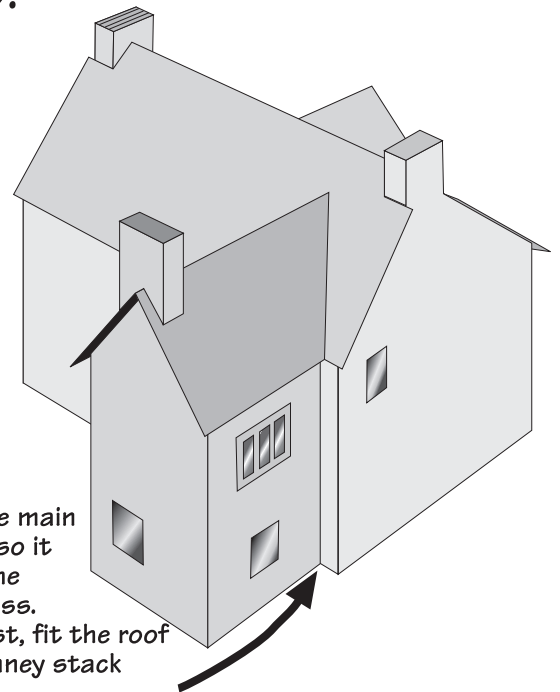

Fig. 6. REAR GABLED BUILDING.



This folds around the grey inner floors in much the same way as the main building. Start by fitting the door, mullioned window and all the glazing, then attach the two floors to two sides and when fast fold and fix the other side walls.



Fix to the main building so it sits in the roof recess. When fast, fit the roof and chimney stack

Fig. 7. Chimney Stack

The rear building has a separate chimney stack that sits on top of the roof.

Fold chimney stack walls around the four short inner chimney formers (in the same way as the two chimneys on the main building) until ends meet.

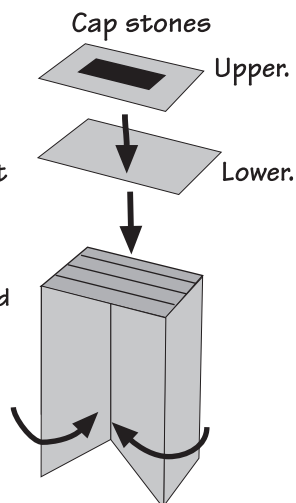

The chimney capping stones are exactly the same for the other chimneys on the main building and the farmworkers cottage.

Fig. 8. REAR LEAN-TO BUILDINGS.

The farmhouse and the cottage both have rear lean-to buildings that assemble in the same way. The only difference between them is the cottage lean-to is shorter.

Fit the door and glazing then fold the walls around held in place with the inner floor which sits on top of the door and the inner tab.

The two small lean-to buildings fit together in the same way except that the inner floor fits at the bottom, behind the door.

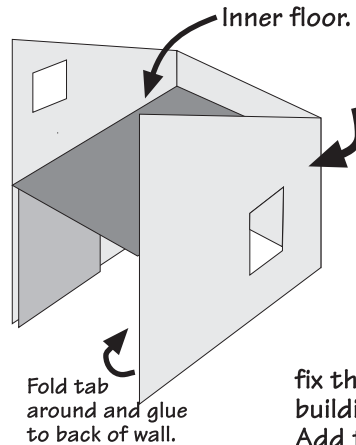

fix the lean-to's to the buildings without their roofs. Add the roof sections when fast. The lean-to buildings don't necessarily need to go where shown, this is only a guide.

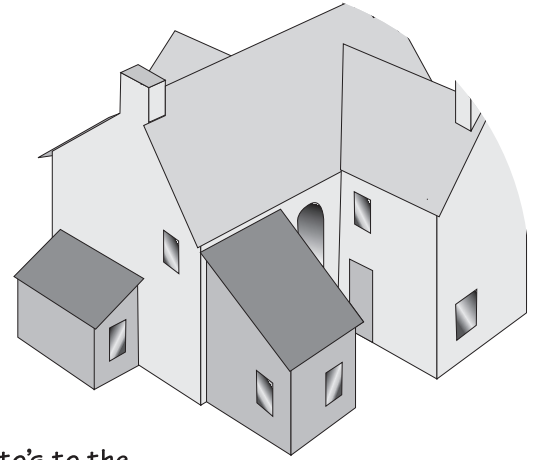
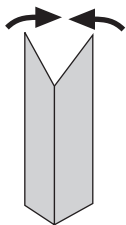

Fig. 9. FARM WORKERS COTTAGE.

The cottage fits together in the same manner as the farm house. The walls fold around the two inner floors. the larger lean-to fits at the back of the cottage covering the wall joint, and the smaller one can be fitted at either side of the building.

There is a small porch to fit around the front door.



The two side walls for the porch fold back to back.

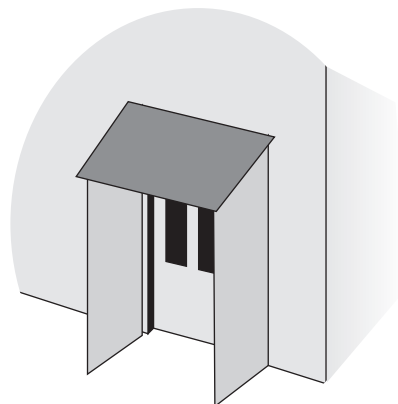

Fix the two side walls to each side of the door opening at right angles then attach the small slate roof.

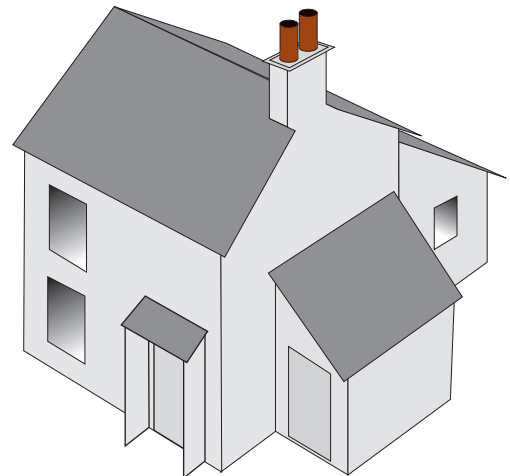

Chimney Pots

PLEASE NOTE - once you have perfected the art of rolling your own chimney pots you will soon realise that they are extremely realistic. Much better than anything made from plastic or white metal. So please be patient & keep trying, the chimney pots make all the difference.

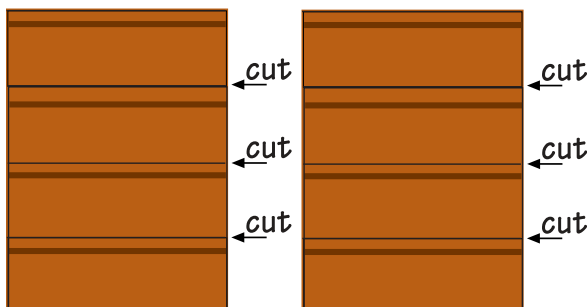
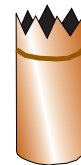

Cut into strips then roll tightly around a nail or drill bit (apx. 3mm dia.) and fix the end with a tiny spot of glue. Paint the insides black to get rid of the white card then finish off by cutting pointed edges with a fine knife or scissors.

Curl strip slightly first.



Roll up tight then unroll the end enough to smear with a little glue then roll backup and hold tight until fast.

