

# PN971 N Scale L/R Bank & Shop

## CHECK LIST

This kit should contain the following:

- 1 x PRINTED SHEET. Kit parts.
- 1 x GREY SHEET. Inner strengthening
- 1 x GREY SHEET L1. Laser cut parts
- 1 x GLAZING sheet.
- 1 x Ridge tiles card.
- 1 x INSTRUCTION BOOKLET.
- 1 x EXTRA BITS sheet.

## READ THROUGH ALL THE INSTRUCTIONS BEFORE YOU START.

This is a complex kit that requires particular attention to detail, so proceed with care!

To construct this kit you will need the following:

1. A modellers knife.
2. A pair of sharp scissors.
3. A steel ruler.
4. Glue - See glues.
5. Ultra Fine Tip Glue Applicator, see below.
6. A cutting surface - a sheet of card or cutting mat.
7. Fine point tweezers.
8. Water colour paints and a very fine brush for painting edges and corners.

## METCALFE Ultra Fine Glue Tip Bottles.

These bottles are essential for gluing the smaller components in this kit.



Tiny strips and spots of glue can be accurately laid down with precision.

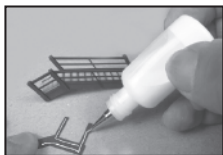

## INSTRUCTIONS

### GLUES

#### UHU Solvent Free All Purpose Adhesive Glue

Works superbly well in our fine glue applicators. Dries quickly, but allows time for positioning of kit parts as described further on in the instructions.

Also Deluxe Materials 'SPEEDBOND'  
A fast drying PVA.

see [www.deluxematerials.com](http://www.deluxematerials.com)

### GETTING STARTED

#### 1 EXTRACTING COMPONENTS FROM THE BASE SHEETS.

To stop the components from falling off the sheets, they are held secure with score lines. These are cuts that only go about 75% of the way through the card.

To release them run the point of your knife along these score lines and they will come seamlessly away. These score lines are marked with blue arrows: WARNING, Cut with care using a knife that is not too sharp, this will reduce the risk of the blade running off the score and cutting the components.

#### 2 MAKE YOUR 'BUILDERS YARD'.

As you extract the components from the base sheets they need to be kept away from your working area on a thick piece of card or a tray until needed. Keep the components organised to which building they belong to.

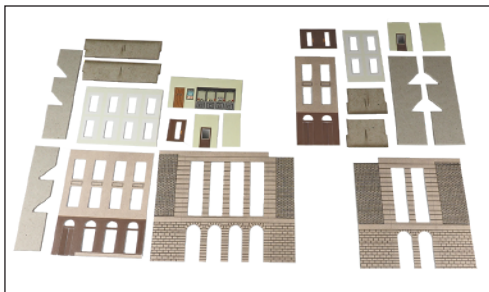

### 3 WINDOW GLAZING

Cut out all the clear glazing components along the outer white lines and place on a separate sheet of dark card so they don't get lost. Note which window frames the glazing matches to, The 'A's' are for building A, 'B's' for Building B and the 'S's' are for the shop building.

**Note** the windows S1 RH & S2 LH need to be folded along the route of the marked dashed line. To get the scoreline in the correct position it is best to gently score along the dashed line **before** cutting out the windows. You're best gently scoring the line first you can always deepen the score when you've completely cut the windows out and you can test the fold. See fig. 6

### 4 PAINTING CORNERS & EDGES.

The white card that shows on the corners and edges is best painted **before you build the kit.**

All you need is a simple set of water colour paints and a fine brush.

Something like this set of 'Reeves' watercolours or even simple child's watercolours.



Mix your colour with lots and lots of water, apx. 1 part paint to 5 parts water or more. **TEST ON WASTE CARD FIRST UNTIL YOU HAVE THE CORRECT SHADE & COLOUR.**

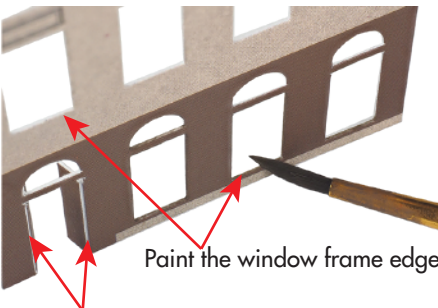

Paint the window frame edges too.

Fold the edges of the card back fully and gently run the point of your brush along the exposed white card.

Only tiny amounts of paint on your brush. It's better to have to go over it a few times than to flood it with paint.

Before the paint dries, run your finger along the edge to rub the colour into the absorbent white card.

Then wipe away any paint that has run onto the printed surface before it dries.

Remember, you only need to just slightly tint the card with a little colour.

**DON'T** paint a thick solid line down the edges, you will only make it look worse.

### 5 STRENGTHENERS.

To help identify with strengtheners go with each building below is a key to the components.

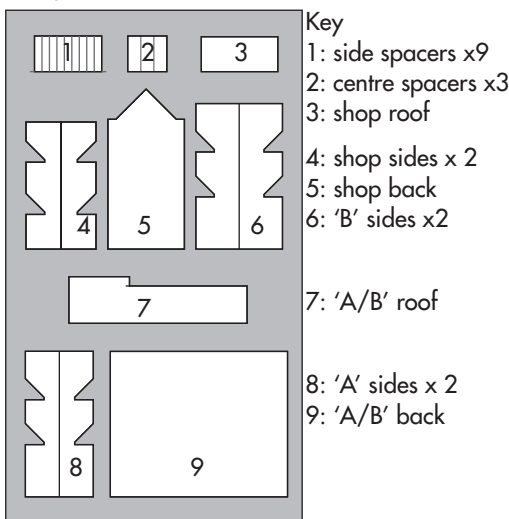

- |                   |                           |
|-------------------|---------------------------|
| 10: 'B' 1st floor | 13: 'A' 2nd floor         |
| 11: 'B' 2nd floor | 14: 'A' window spacers x3 |
| 12: 'A' 1st floor | 15: 'A/B' capping x 2     |

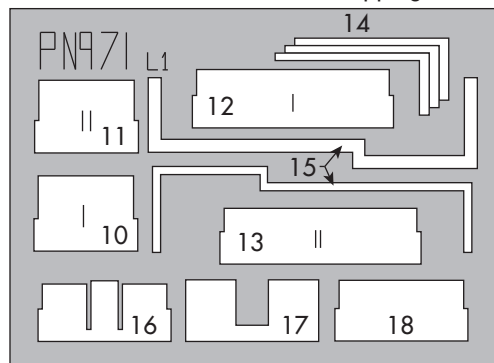

- |                    |
|--------------------|
| 16: shop 1st floor |
| 17: shop base      |
| 18: shop 2nd floor |

# LETS START TO BUILD!

## BUILDING 'A'

### Fig.1. GROUND FLOOR

Start by carefully aligning and glueing into position window A1 to the back of Bank building 'A' window openings. Leave the other windows to one side until needed later.

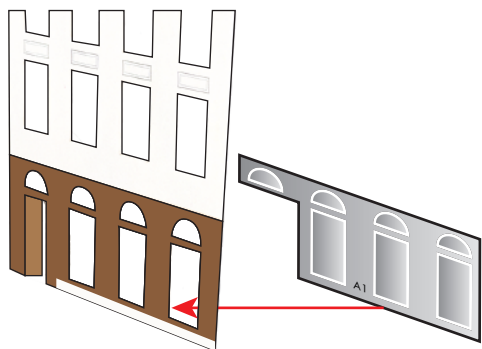

Now fix the window openings to the back of the Bank building 'A' front and side walls, keeping the bottom edges flush.

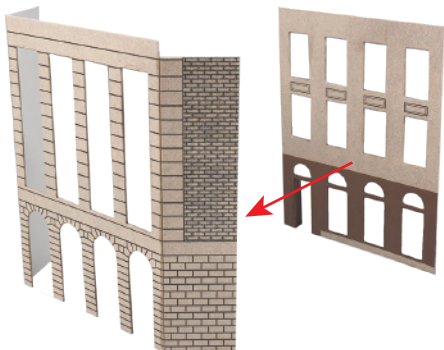

Add the 2 'A' side strengtheners (8 on key) flush into the corners on both side walls.

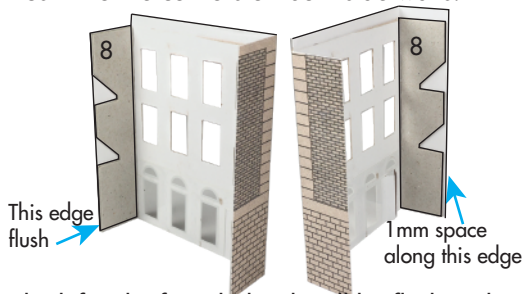

The left side (from behind) will be flush to the back edge, the right side will have a 1mm approx gap to the back edge.

Combine 3 of the side spacers (1 on key) to make a solid block, keeping all edges flush.

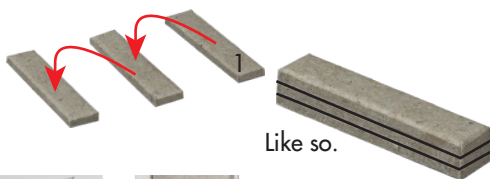

Like so.

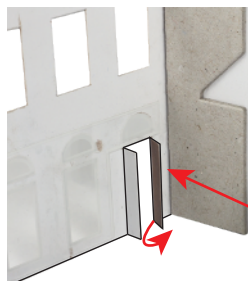

This block then fits flush between the side strengthener and the inner door.

Fold back the inner door wall and glue flush to the block.

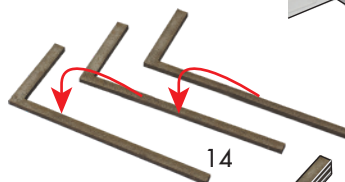

Like so.

Now combine the 3 'A' window spacers (14 on key) to form a solid block, again keeping all edges flush.

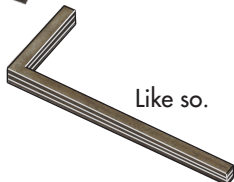

Like so.

First add the 'A' Inner wall with the door flush to the side strengthener.

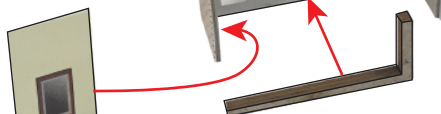

Then the 'L' shaped block again folding back the inner door wall flush to the block.



Like so.

Add the door "A" glazing to the back of Door 'A' then fix into the doorway, keeping the left hand edge flush to the side wall strengthener.

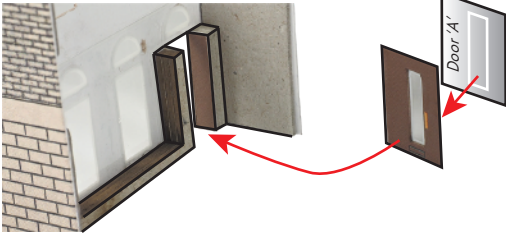

Next, the door 'A' ceiling goes across the top of the doorway, printed side down.

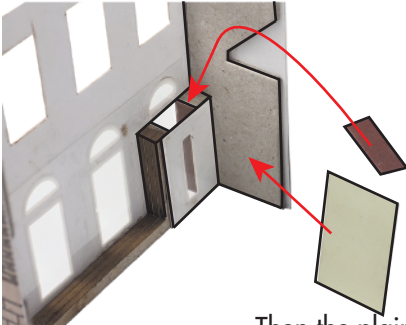

Then the plain bank building 'A' inner wall fixes flush to the side wall strengthener.

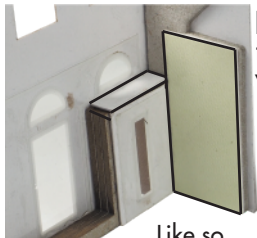

Like so.

**Fig.2. UPPER FLOORS**

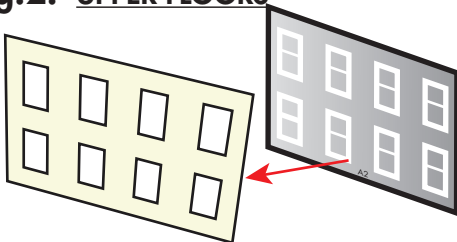

Add the glazing 'A2' to the back of the bank building 'A' window frames carefully aligning the windows to the openings.

**Be careful not to get the frames the wrong way around, the distance from the openings to the edge is shorter at the base than the top.**

If you'd like to add curtains or blinds to the upper floor windows, now is a good time to add them.

To fit curtains fix a small strip of waste card to each side of the window, then glue the curtain to the waste card so that it shows through the window (the waste card will space the curtain back from the window a little giving a greater effect of depth).

For extra curtains, visit this product on our website [www.metcalfe-models.com](http://www.metcalfe-models.com)

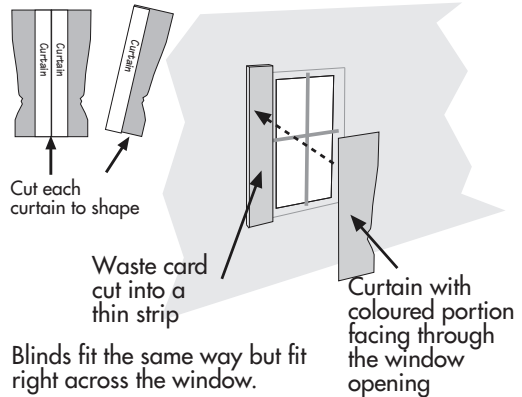

Blinds fit the same way but fit right across the window.

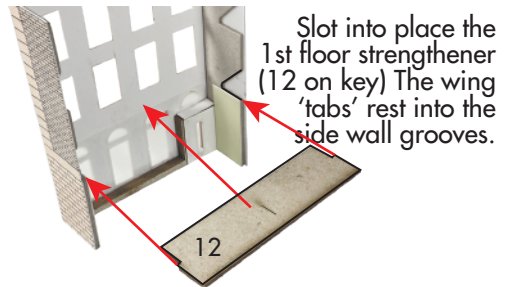

Now add the window frames to the back of the build.

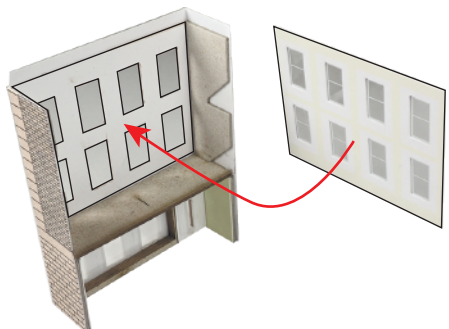



Lastly the 2nd floor strengthener (13 on key) again slotting the wing 'tabs' into the corresponding grooves on the side wall strengtheners.

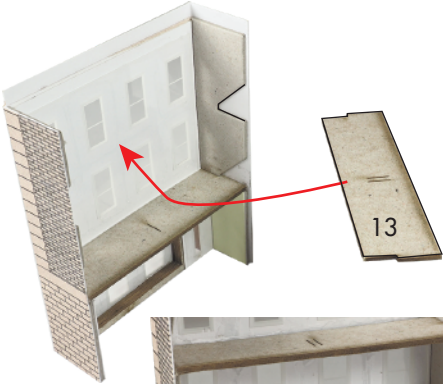

Add the bank building 'A' window seat to the top of the window spacer block.

Now put this build to one side and onto building 'B'.

### BUILDING 'B'

**Fig.3. GROUND FLOOR**

Start off by fixing the bank building 'B' window openings to the back of 'B' front and side walls, centre and keep the base edges flush.

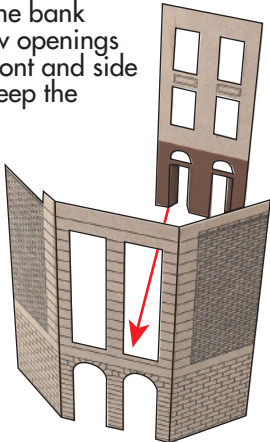

Position the 2 side wall strengtheners (6 on key) to the back of the side walls. Fit flush into the corner.

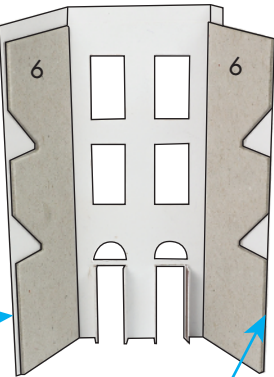

The left hand side will have an approx 1mm gap from the printed side wall rear edge.

The right hand side will be flush to the printed edge.

Now to create some more blocks. Combine the 3 centre spacers (2 on key) into one solid block. Then remaining 6 side spacers (1 on key) into two blocks comprising of 3 spacers each.

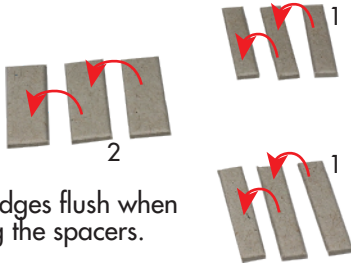

Keep all edges flush when combining the spacers.

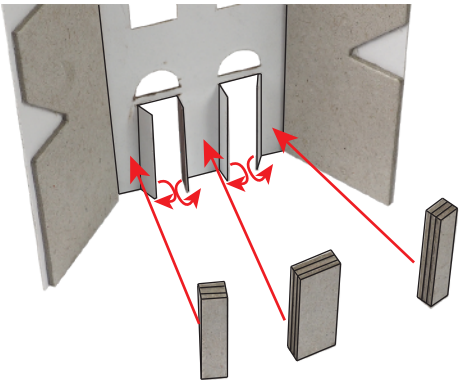

Now glue the spacer blocks into place, the larger centre block in the centre, to two smaller side blocks to either side. Keep the bottom edges flush to the outer walls and fold back the inner door walls to the sides of the blocks.

Fold in the side walls and glue to the side spacers.

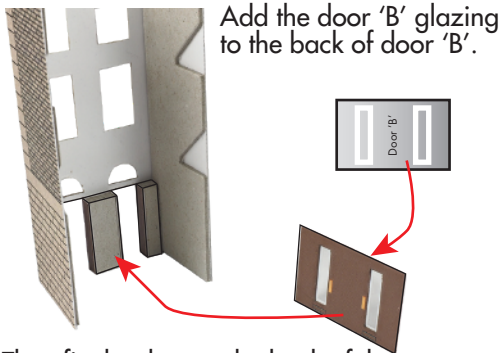

Add the door 'B' glazing to the back of door 'B'.

Then fix the door to the back of the spacer blocks, keeping the bottom edges flush.

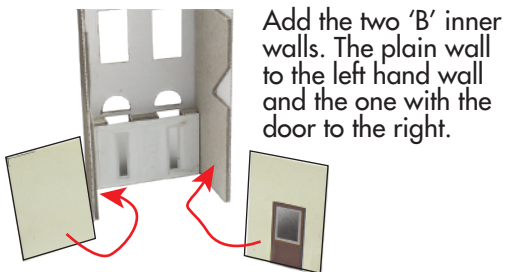

Add the two 'B' inner walls. The plain wall to the left hand wall and the one with the door to the right.

Keep the inner walls flush to the rear edge of the side wall strengthener.

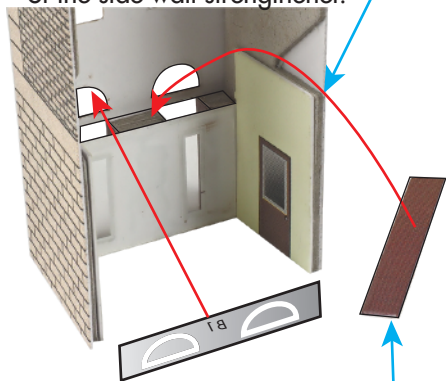

Add the glazing B1 to above the door, carefully aligning the windows to the openings.

Then add the door 'B' ceiling brown side down to the top of the doorway spacers.

Now add the 1st floor strengthener (10 on key) like before the wing tabs fit into the slots on the side wall strengtheners.

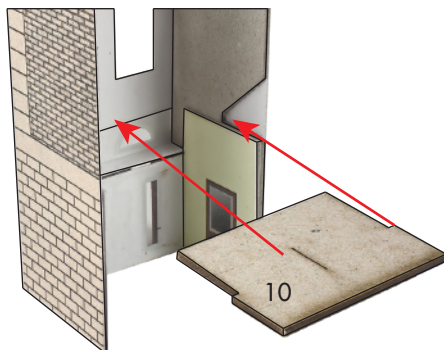

Add B2 glazing to the back of building 'B' window frames, carefully aligning the windows to the openings.

**Like Building A be careful not to get the frames the wrong way around, the distance from the openings to the edge is shorter at the base than the top.**

If you'd like blinds/curtains adorning these windows, best fit them now. See fig. 2

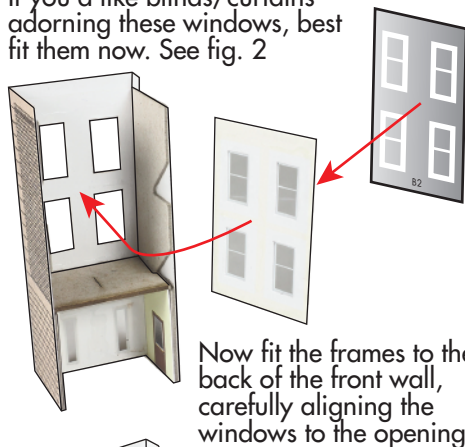

Now fit the frames to the back of the front wall, carefully aligning the windows to the openings.

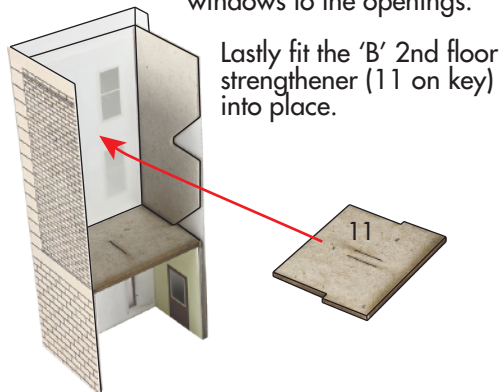

Lastly fit the 'B' 2nd floor strengthener (11 on key) into place.

## BUILDINGS 'A' & 'B'

### Fig.4. COMBINING THE BUILDINGS

Fix building 'A' & 'B' together along the shorter side wall (the walls that are flush with the side strengtheners and with the internal doors)

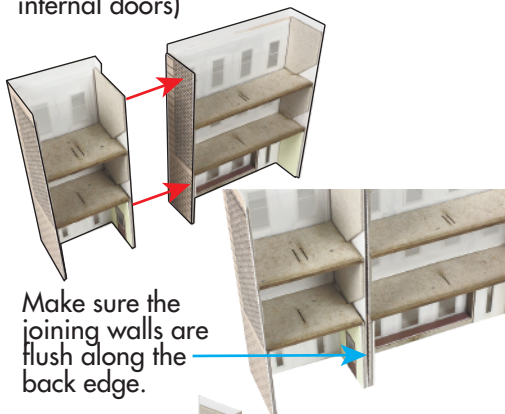

Building 'B' steps out from building 'A'.

Like so.

Now add strengthener 'A/B' roof (7 on key) This covers both buildings and sits flush to the side wall strengtheners.



The 'A/B' back (9 on key) fits flush to the side strengtheners and tight to the underside of the 'A/B' roof.

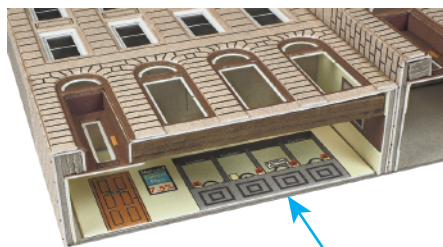
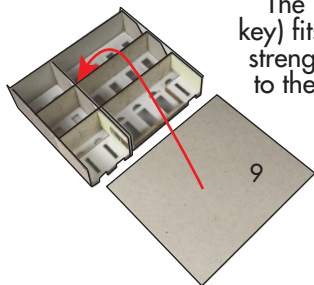

Flip the building onto it's back and slot into place the interior.



Then add the bank building base, keeping the sides and back edges flush.

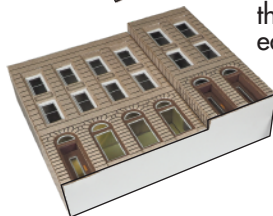

Like so.

### Fig.5. FASCIA, CAPPING & ROOF

There are 3 fascia strips for both buildings 'A' & 'B'. One deep, one medium and one narrow. Start with the deep fascia strip for building 'B'.

Turn the building upside down so it's resting on it's roof.

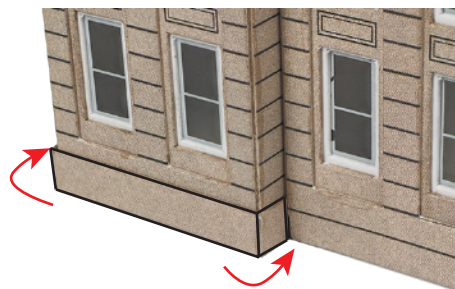

Wrap the deep fascia for building 'B' around the roof edge keeping the edges flush and the small end piece tucked tight into the join where it meets Building 'A'.



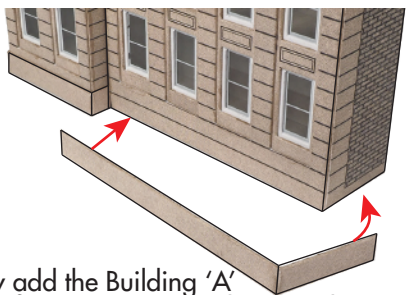

Now add the Building 'A' deep fascia strip. Again keeping the roof edges flush.

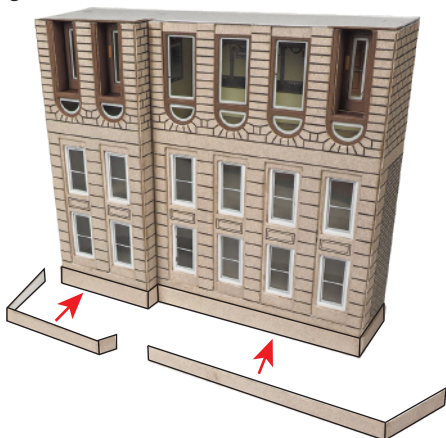

Repeat the process with both the medium and narrow strips, always starting on building 'B' then onto building 'A'.

Finishing with a three 'stepped' fascia.

Like so.

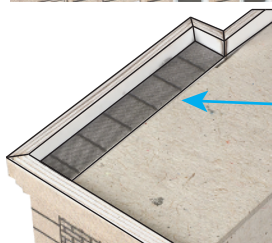

Add the bank building 'B' flat roof flush to the front of the roof wall.

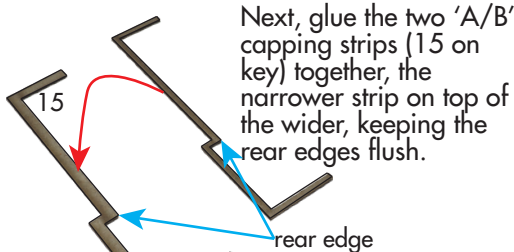

Then affix to the top of the roof wall, keeping an even overhang on all sides.

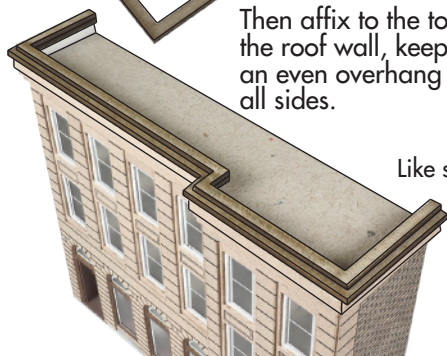

Like so.

Fold in the side roof sections and slide the front of the roof along the base of the roof wall until flush to the front and the 'B' Flat roof section. Then fold out the side sections so that they are flush to the side walls.

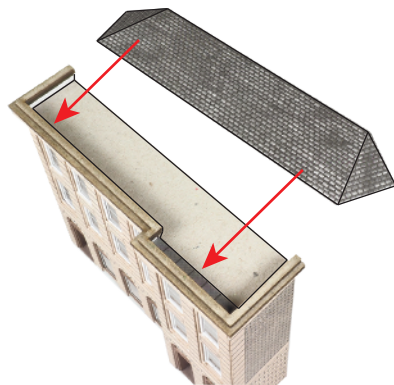

A view of the roof from behind.



Like so.



All that's left to do is add a sign. Like the fascia strips add the sign to building 'B' first then the longer building 'A' sign.

Now onto the shop.

### SHOP BUILDING

**Fig.6. SHOP FRONT & WINDOW**

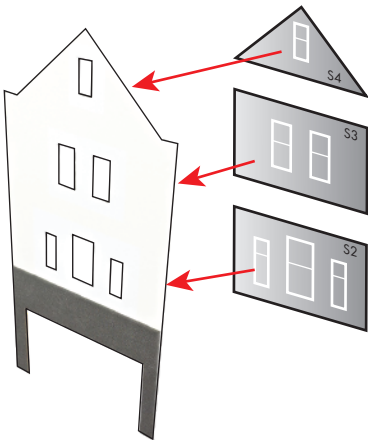

Start off by matching the glazings S2, S3 and S4 to the shop inner wall and window frames. Carefully align the windows to the openings. If you'd like curtains or blinds behind these windows add them now. Refer to Fig. 2 for curtain instructions.

Now add the inner wall to the back of the shop front and side walls, keep the base edges flush and the windows centred through the openings.

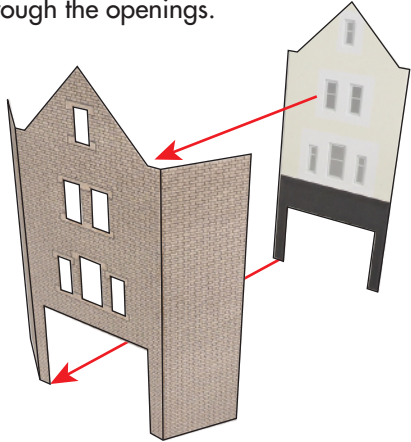

Place to one side and move onto the shop window.

S1 RH & LH windows - these both need to be folded 90 degrees. Carefully line up your ruler along the dashed line and gently score the glazing.

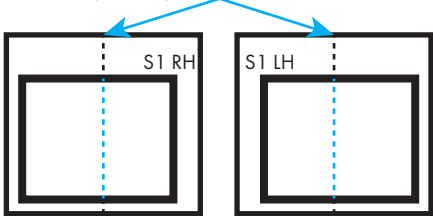

Fold both the glazing and shop window left and right to a right angle. (choice of either green or blue colour themes)

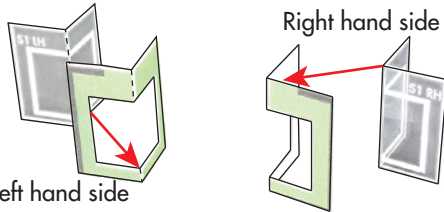

Then align the glazing to the corresponding frame, keeping them at a right angle. Note the black stripe, this is the front.



Fix the two windows to the shop base (17 on key) keeping the bottom edges flush to the base card.

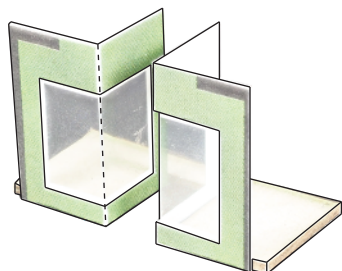
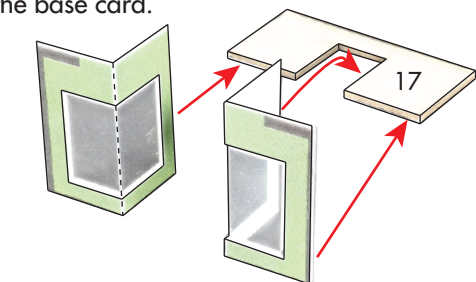

Like So.

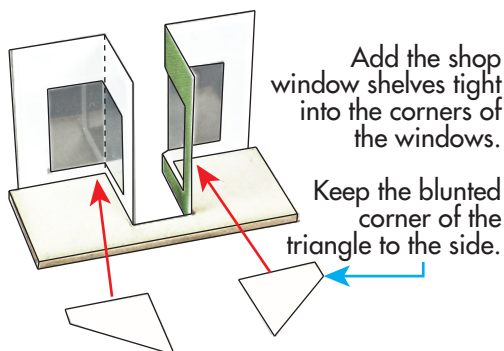

Add the shop window shelves tight into the corners of the windows.

Keep the blunted corner of the triangle to the side.

Fold back the tab under the window displays and glue flush against the back edge of the window shelves.

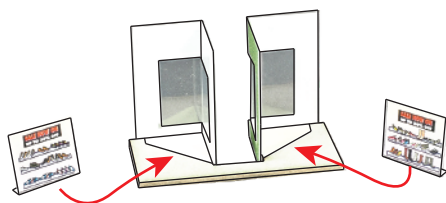

Add the shop door glazing to the back of the shop door (again choice of either green or blue) aligning the window through the opening. Then attach the door to the back edges of the 2 shop windows and flush to the base.

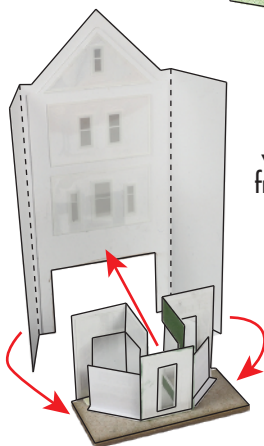
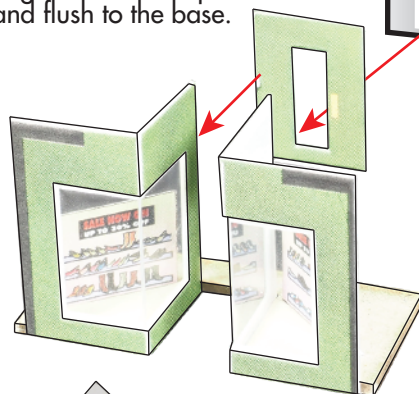

Now fix the completed shop window to the shop front and side walls, folding the side walls around the sides of the base.



Like So.

## Fig.7. SHOP FLOORS & ROOF

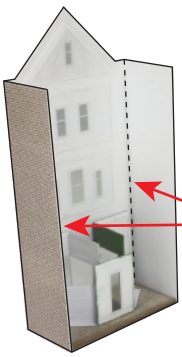

Slot the two shop side strengtheners (4 on key) to the back of the side walls, fixing them tight into the corner leaving a 1mm approx gap along the back edge of the strengthener to the side wall.

Add the shop 1st floor strengthener (16 on key) the shop window frames fit into the slots and the floor rests on the side wall slots and the top of the door and flush the front wall.

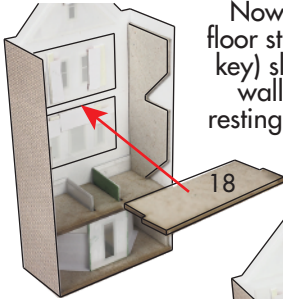
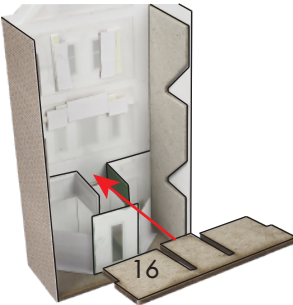

Now add the shop 2nd floor strengthener, (18 on key) slotting into the side wall strengtheners and resting in between the S2 and S3 windows.

The shop roof strengthener (3 on key) rests atop the side strengtheners.

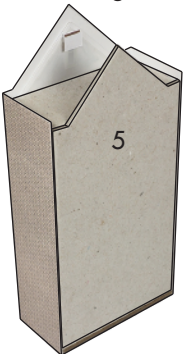
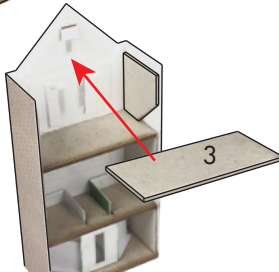

Then add the shop back (5 on key) this fits on top of the base and flush inside the outer walls tight against the side and floor strengtheners.

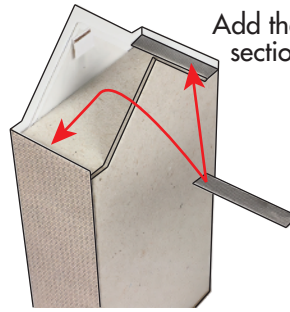

Add the two shop flat roof sections flush against the side walls.

The shop roof positions on top of the shop back and the S4 window and the edges fit flush to the flat roof sections.

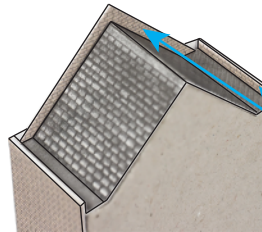
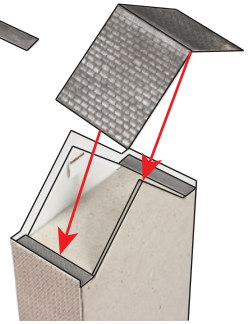

Add the inner roof side walls and the inner roof wall flush against the roof sections and flush to the outer wall tops.

The shop corner stones next, simply glue these strips down each of the corner walls.

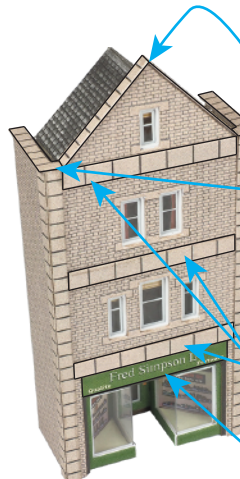
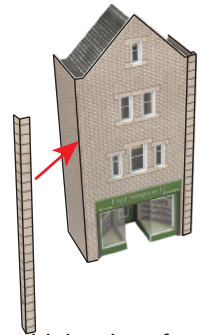

Add the shop front capping stones and side capping stones to the roof wall tops, Fit the roof stones first, then butt the side capping up flush to them.

The three shop fascia strips across the front.

And a sign of your choice across the black strip above the shop windows. Test the fit first and trim if required.

Like So.

Tip the shop onto it's back and add the shop base flush to the sides and back, so that the brown shows from underneath.

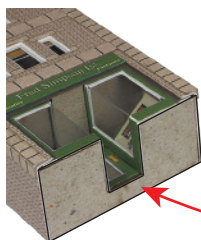

Then add the shop doorway floor pattern flush against the doorstep in between the shop windows.

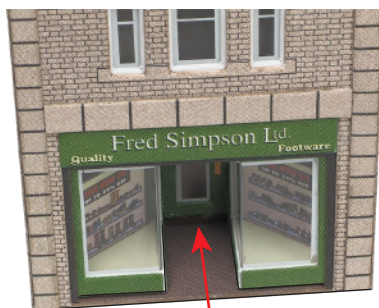

Finally add some ridge tiles along the apex of the roof sections.

