

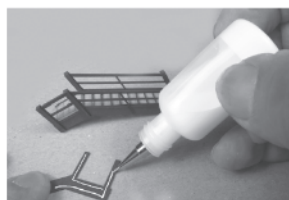
# PO279 OO Scale Low Relief DEPARTMENT STORE

**READ THROUGH ALL THE  
INSTRUCTIONS BEFORE YOU START.**

To construct this kit you will need the following:

1. A Modellers knife.
2. A pair of sharp pointed scissors.
3. A steel ruler.
4. Glue - UHU Clear Adhesive is our favourite.
5. Ultra Fine Tip Glue Applicator, *see right*.
6. A cutting surface - a sheet of card or a cutting mat.
7. Fine point tweezers to hold the smaller components.
8. Water colour paints and a very fine brush, for painting the edges and corners.

**The METCALFE Ultra Fine Tip  
Glue Bottles** are essential for gluing  
the smaller components in this kit.



Tiny strips or spots  
of glue can be  
accurately laid down  
with precision.



Always replace the pin after use and  
store the bottles upside down to keep the glue moist.

## UHU All Purpose Adhesive Glue

Is available in standard and solvent free. Both types  
are fine for use in our glue bottles, even though the  
instructions on the back of the packs warn against  
solvent based glues, we have tested the UHU solvent  
based glue and it works fine. The solvent free glue  
doesn't string as much, but can be a little harder to  
clean off if it drips onto unwanted areas.

## Speed Bond by Deluxe Materials

This is an excellent PYA. based glue that dries quickly,  
but also allows time to get parts into position. It has  
the added advantage that it dries clear leaving little  
evidence if it oozes out of joints etc. Used in our fine  
glue applicator bottles a 112g bottle lasts for ages.  
[www.deluxematerials.com](http://www.deluxematerials.com)

## GETTING STARTED

### 1 EXTRACTING COMPONENTS FROM SHEETS.

To stop the components from falling off the sheets, they  
are held secure with scorelines. These are cuts that only  
go about 75% of the way through the card.

To release them simply run the point of your knife along  
the scorelines and they will come seamlessly away.

These scorelines are indicated with blue arrows: ➡

**WARNING,** Cut with care using a knife that is not too  
sharp, this will reduce the risk of the blade running out  
of the score and cutting the kit components.

The Laser cut components are held to the sheet with tiny  
score points, these parts can be carefully pushed out  
from the base sheet.

## INSTRUCTION SHEET 1

### CHECK LIST

This kit pack should contain the following:

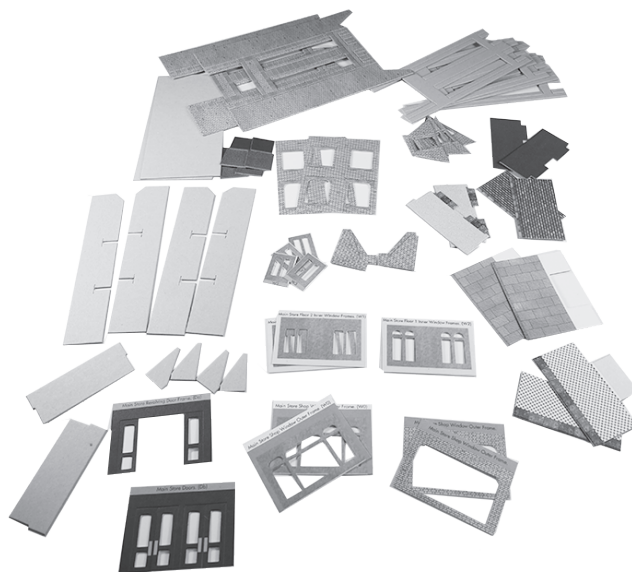
- 1 x SHEET A - Printed shop parts
- 1 x SHEET B - Printed shop parts
- 1 x SHEET C - Window frames & internal parts
- 1 x SHEET D - Internal shop displays
- 2 x PLAIN GREY CARD 1 - Main strengthening parts.
- 1 x PLAIN GREY CARD 2 - Corner strengthening parts.
- 1 x Glazing sheet - A clear plastic window sheet.
- 1 x PLAIN GREY CARD - a small sheet with laser cut parts.
- 1 x DARK BROWN CARD - a small sheet with laser cut parts.
- 3 x INSTRUCTION SHEETS.

### 2 MAKE YOUR 'BUILDERS YARD'.

This is an area kept away from your working surface, where  
you store ALL components extracted from the base sheets  
until needed.

Use a piece of thick card or a tray to make your builders yard.

To avoid confusing the parts, start off by only  
removing the parts labelled with the prefix  
'Main Store' from sheets A & B. Leave the parts  
labelled 'Corner Store' until later or put them  
into a separate Builders Yard. All the  
components from Sheet C can be extracted.



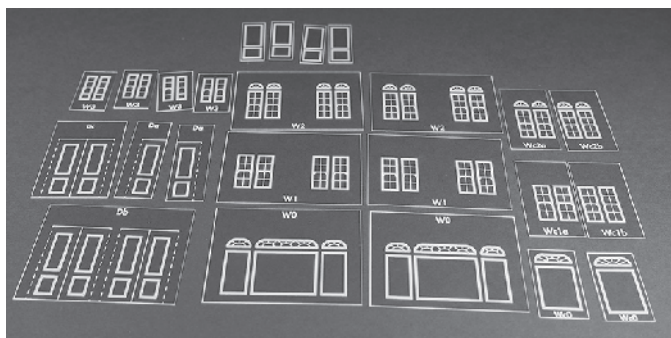
**NOTE:** The above photo shows all the components for  
the Main Store building.

Your **WORKING** area should have a clean flat surface, and  
should only contain the kit parts you are actually working on.

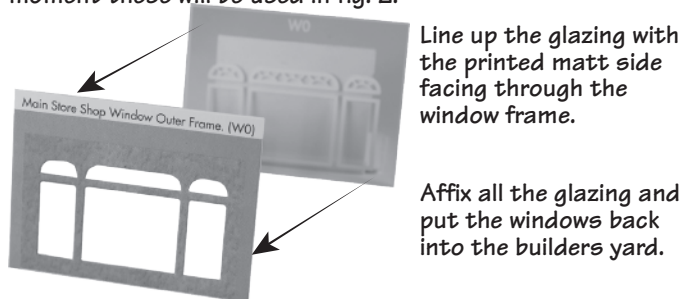
**EVERYTHING ELSE SHOULD BE KEPT NEATLY ARRANGED  
IN THE BUILDERS YARD, UNTIL NEEDED.**

**PLEASE NOTE:** Don't throw anything away. Keep all the  
waste card in a box until the kit is finished, just in case  
you can't find anything. The chances are that it will be there.

**Fig. 1. WINDOWS**



The windows match up with the door and inner window frames on sheet C simply match the code numbers with the frame. Put the 4 rotating door windows to one side for the moment these will be used in fig. 2.



Line up the glazing with the printed matt side facing through the window frame.

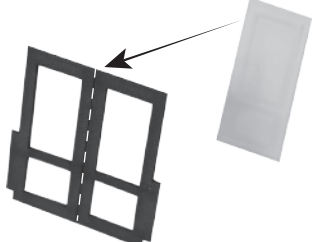
Affix all the glazing and put the windows back into the builders yard.

**Fig. 2. ROTATING DOOR**

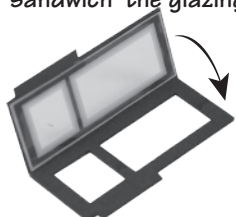
The dark brown sheet holds all the parts for the rotating door. Carefully extract them from the base sheet.



These 2 components fold down the middle to create a single door. Make sure the score line folds easily. Then align 1 of the rotating door glazing and glue into place.



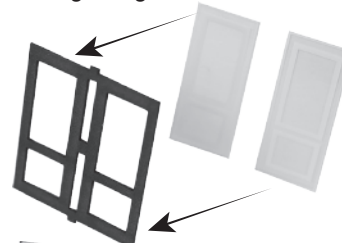
Then fold back onto itself to 'sandwich' the glazing.



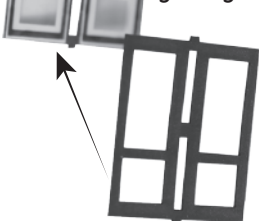
Repeat for the opposite single door.



These 2 components combine to create a double door. First off, carefully align and glue into place 2 of the rotating door glazing.

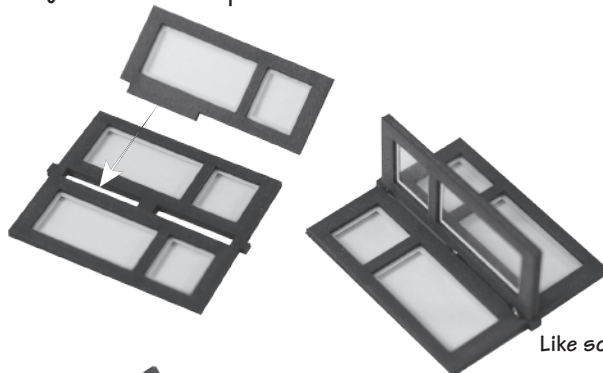


Now fix the matching door to 'sandwich' the glazing.

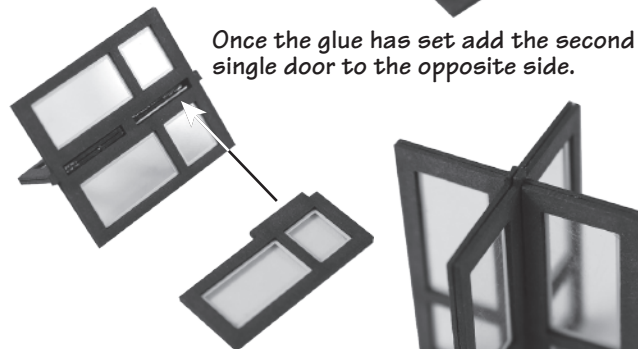


**Fig. 2. ROTATING DOOR cont..**

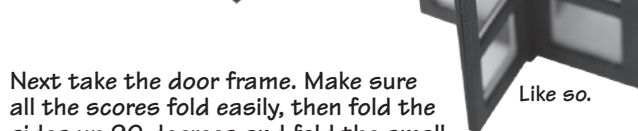
Now add the single doors to the double door. They slot into the spacers on the double door.



Like so.

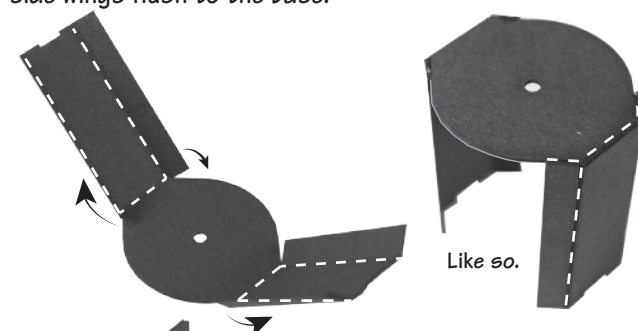


Once the glue has set add the second single door to the opposite side.

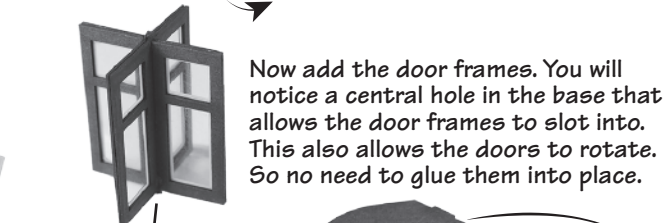


Like so.

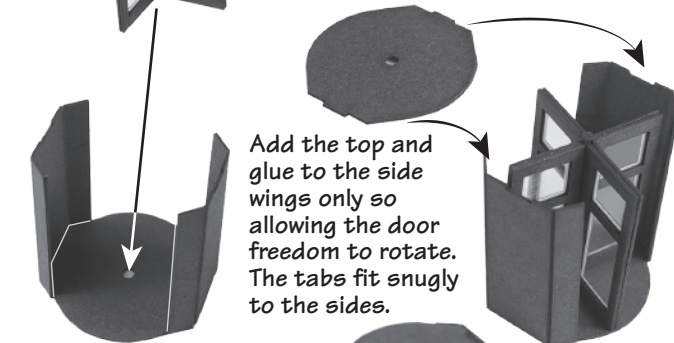
Next take the door frame. Make sure all the scores fold easily, then fold the sides up 90 degrees and fold the small side wings flush to the base.



Like so.



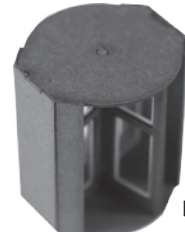
Now add the door frames. You will notice a central hole in the base that allows the door frames to slot into. This also allows the doors to rotate. So no need to glue them into place.



Add the top and glue to the side wings only so allowing the door freedom to rotate. The tabs fit snugly to the sides.

Put the door back into the builders yard.

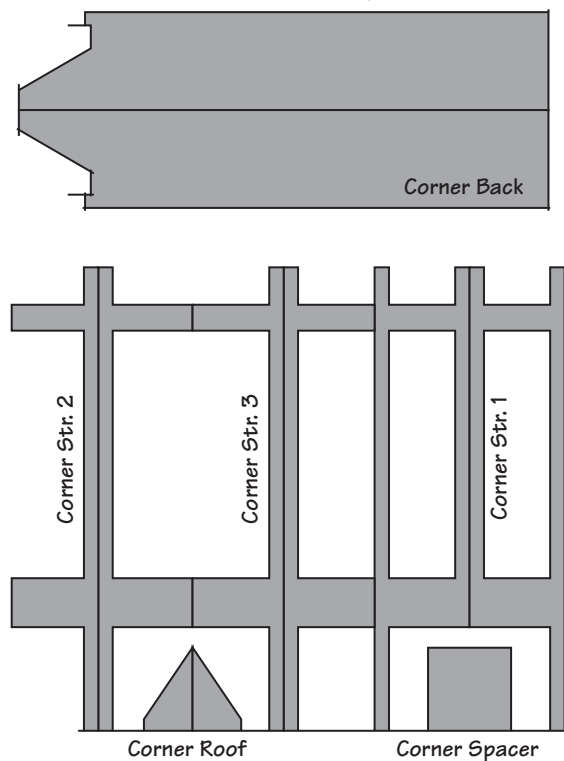
It can be installed as part of the main building or the corner building.



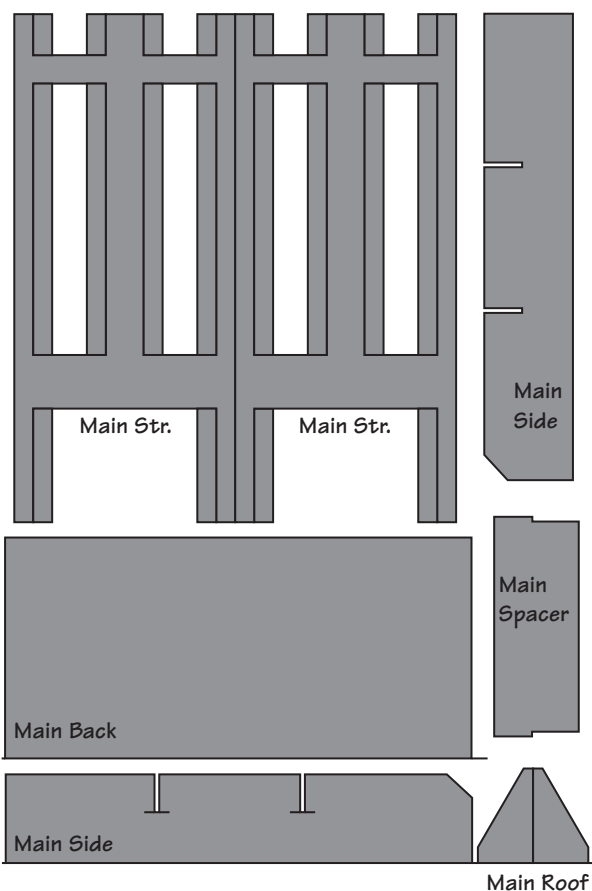
Like so.

# Fig. 3. STRENGTHENER PLAN

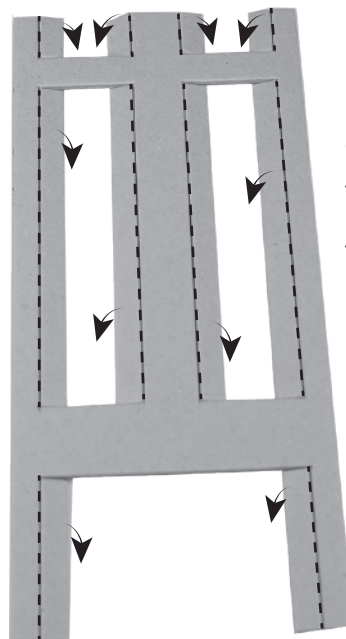
Corner Building Strengthener (1 per kit)



Main Building Strengthener (2 per kit)



# Fig. 4 . MAIN BUILDING STRENGTHENERS



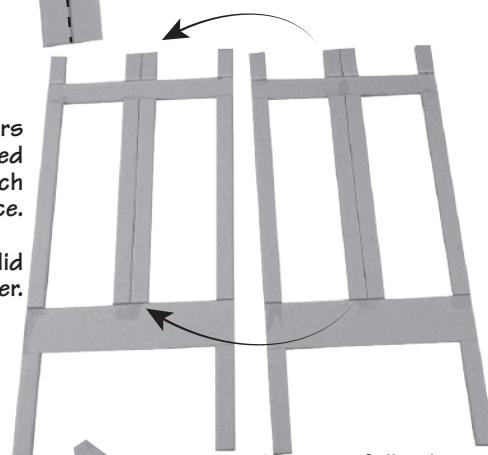
Start off with the 2 main strengtheners.

Fold and glue back the inner tabs on both strengtheners.

You will end up with 2 strengtheners with double thick folded vertical columns.

Align the 2 strengtheners together with the folded back columns against each other and glue into place.

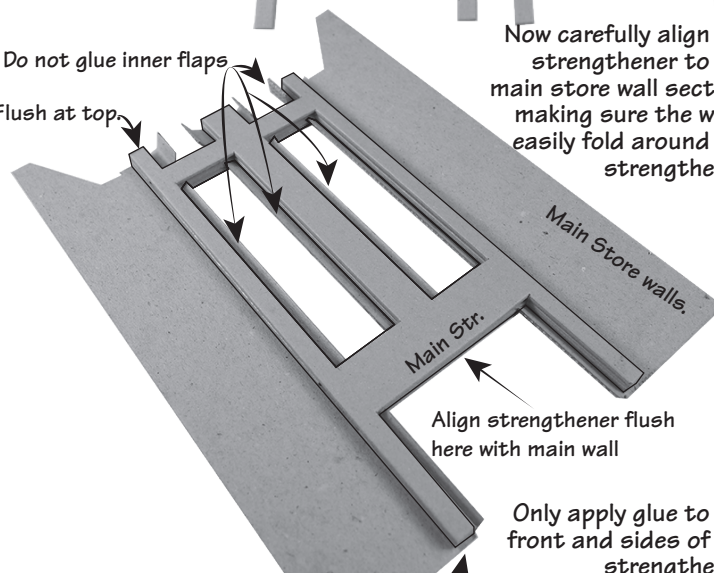
Creating a single solid inner strengthener.



Do not glue inner flaps

Flush at top.

Now carefully align the strengthener to the main store wall section, making sure the walls easily fold around the strengthener.



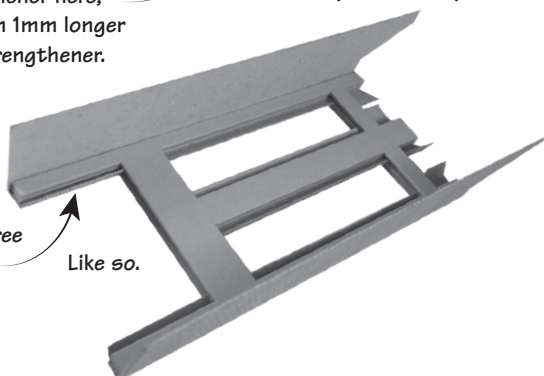
Align strengthener flush here with main wall

Only apply glue to the front and sides of the strengthener. DO NOT glue the inner flaps at this point

The outer walls overlap the strengthener here, making them 1mm longer than the strengthener.

All inner flaps left free and NOT glued into place.

Like so.

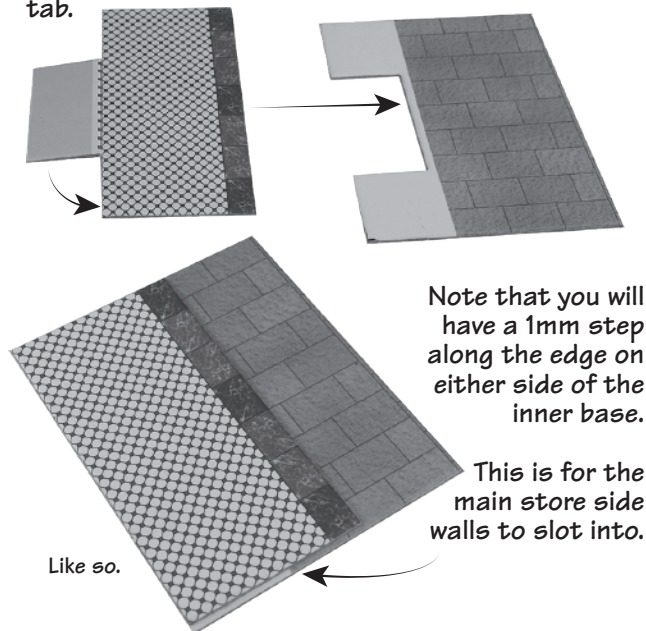




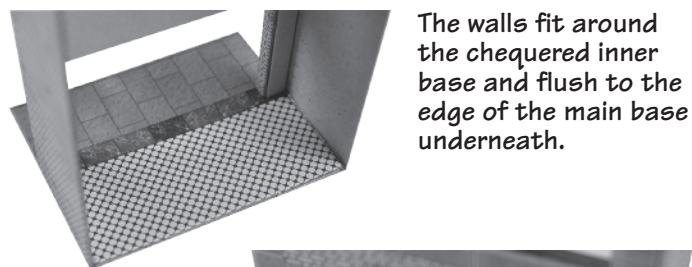
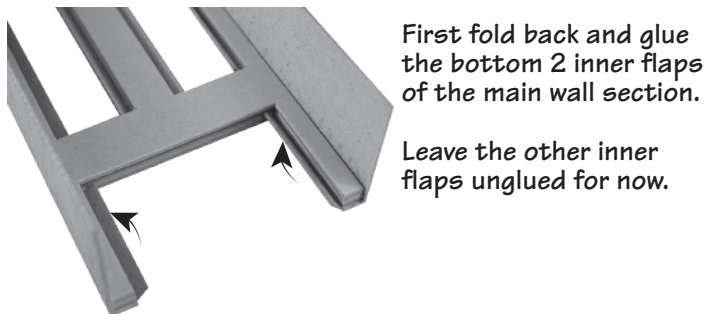
## Fig. 5. MAIN STORE BASE

First take the Main Store Inner Base and fold back and glue into place the yellow tab.

Then using the yellow tab as a guide glue into place onto the Main Store Base.

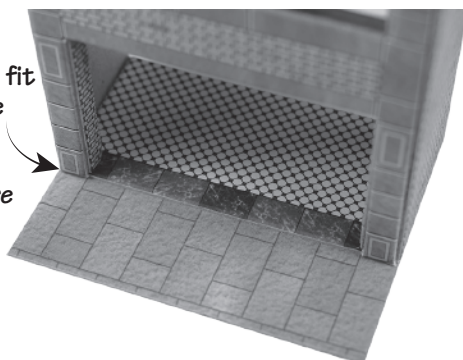


## Fig. 6. ATTACHING THE WALLS TO THE BASE



The front 'pillars' fit flush against the inner base.

Test the fit before gluing.

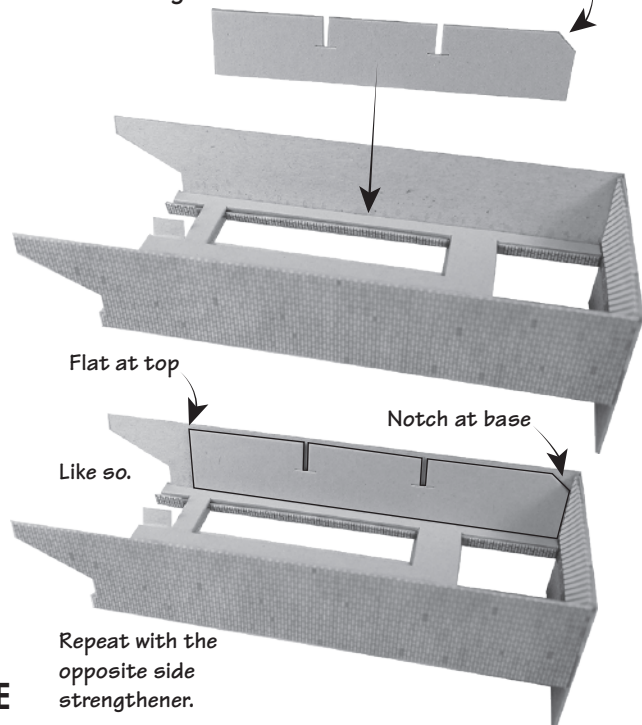


## Fig. 7. SIDE STRENGTHENERS

Now add the main side strengtheners.

Make sure this notch is flush to the base.

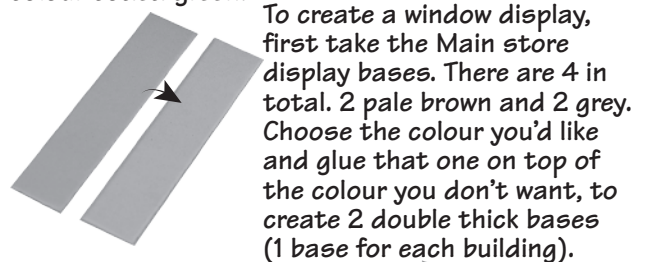
These fit flush up against the front wall strengthener and to the base.



Make sure that the glue has fully dried before continuing. This is a good time to make up the other main store section to this stage while this one dries.

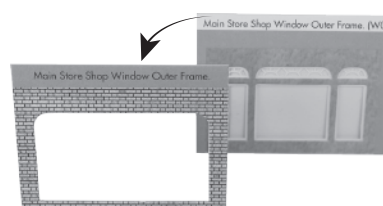
## Fig. 8. MAIN STORE WINDOW/DOOR

You have 3 choices for the main store ground floor. You can have it as a display window or as a pair of doors or the rotating door from fig. 2. These are all colour coded green.



Now choose a display from sheet D and fold along the dotted line.

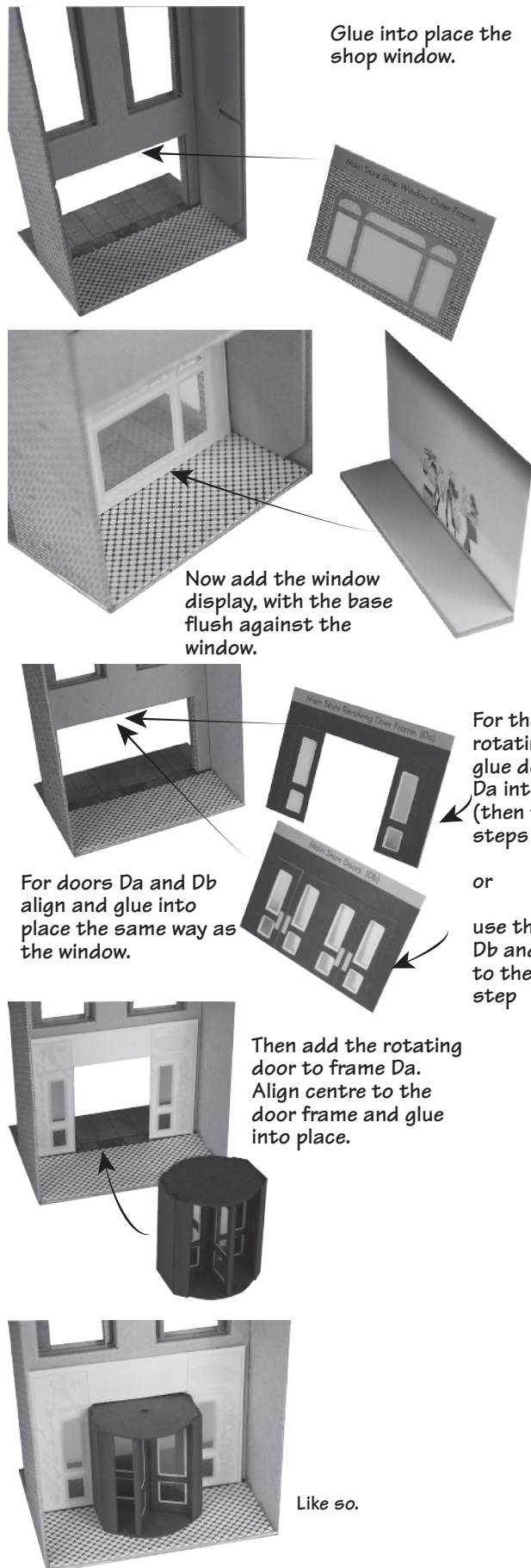
Glue this to the underside of the display base.



Next align flush and glue together the main store window WO to the outer window frame.

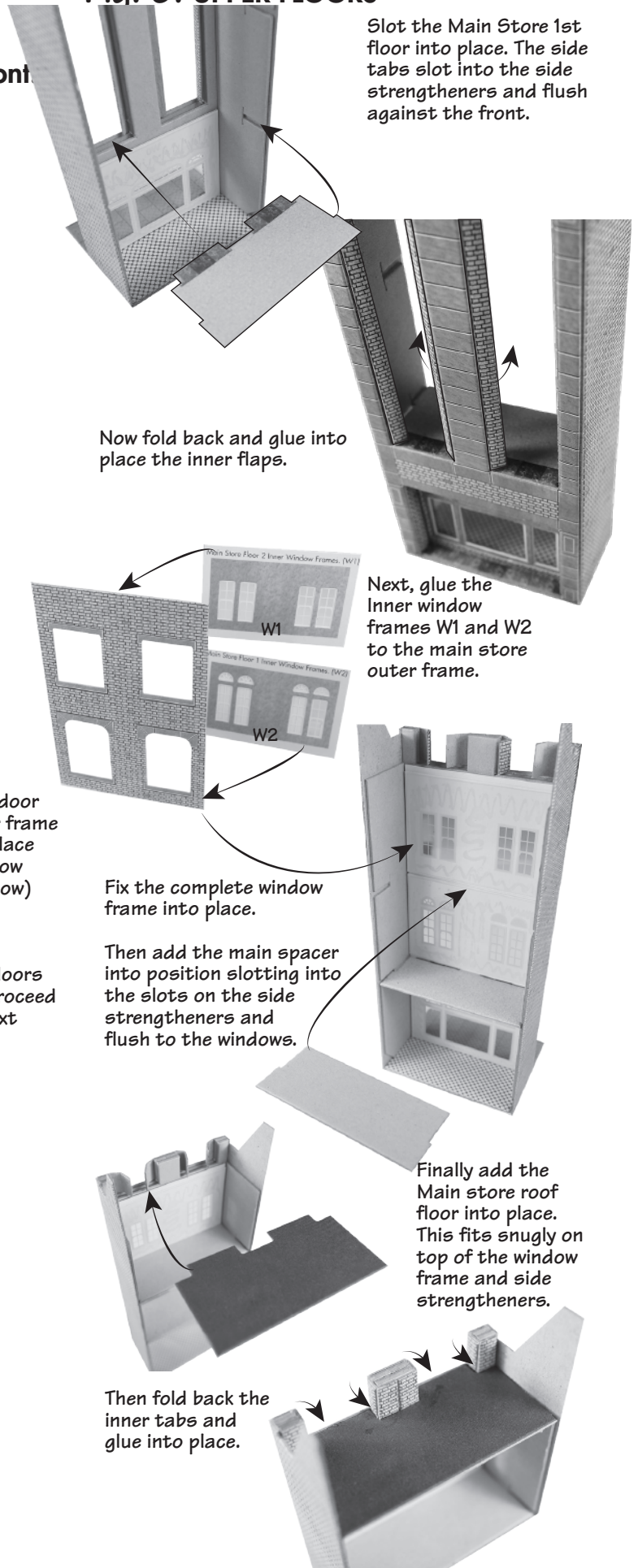
# PO279 OO Scale Low Relief DEPARTMENT STORE

Fig. 8. MAIN STORE WINDOW/DOOR cont.



## INSTRUCTION SHEET 2

Fig. 9. UPPER FLOORS

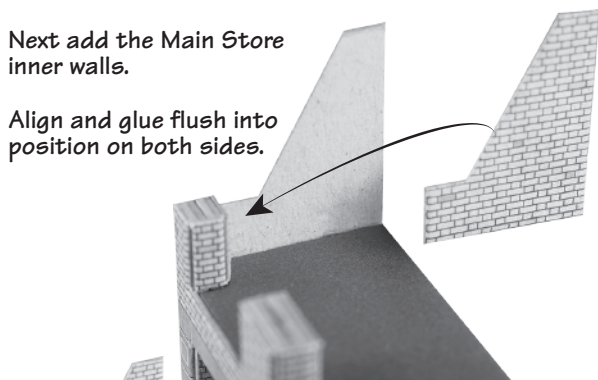




## Fig. 10. ROOF

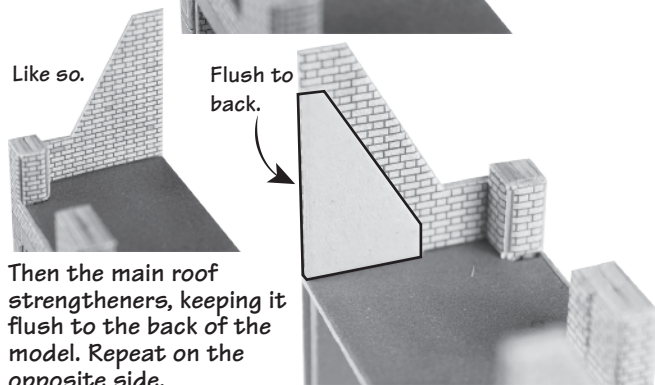
Next add the Main Store inner walls.

Align and glue flush into position on both sides.



Like so.

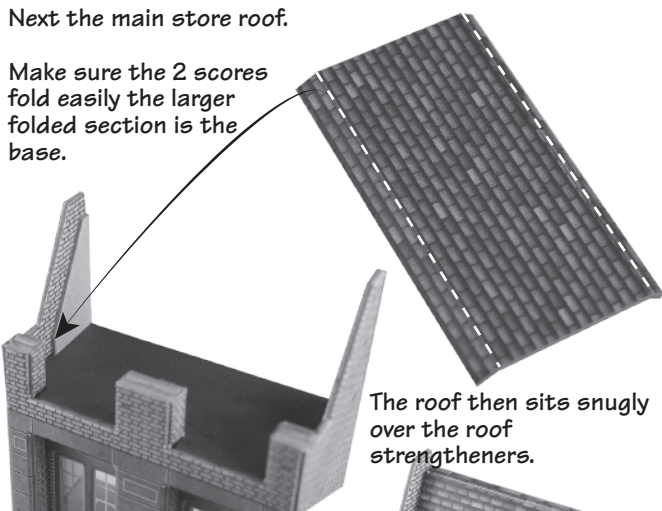
Flush to back.



Then the main roof strengtheners, keeping it flush to the back of the model. Repeat on the opposite side.

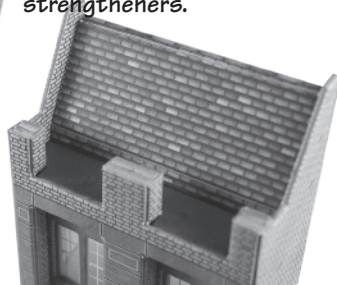
Next the main store roof.

Make sure the 2 scores fold easily the larger folded section is the base.



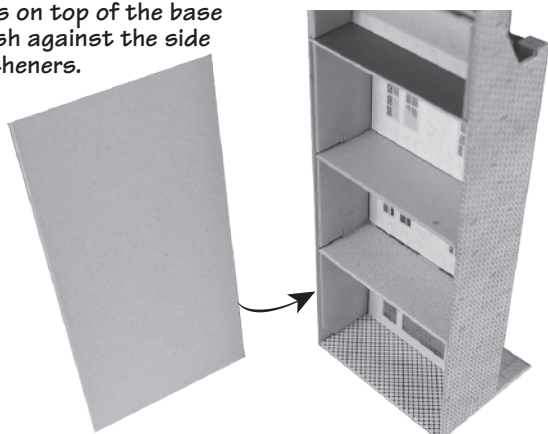
The roof then sits snugly over the roof strengtheners.

Like so.



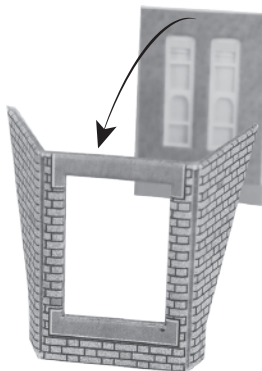
Now fit the main back strengthener into place.

This fits on top of the base and flush against the side strengtheners.



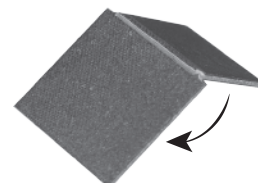
## Fig. 11. DORMER WINDOWS

First off align and glue into place the dormer window frames W3 to the outer windows.

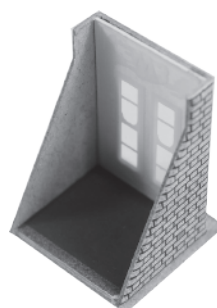
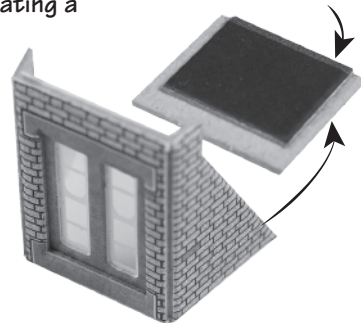


Then fold back the dormer roof and glue to itself creating a double thickness.

Then wrap the dormer window around the solid black square on the underside of the roof.



Fold to rear.



Like so.

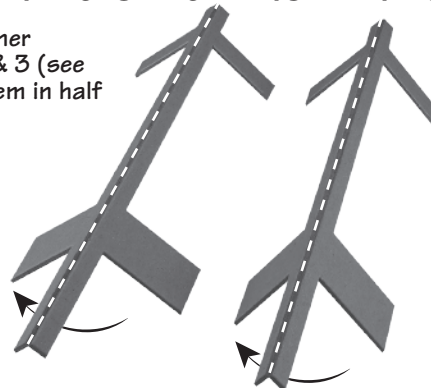


Now add them to the Main roof centring them between the wall sections.

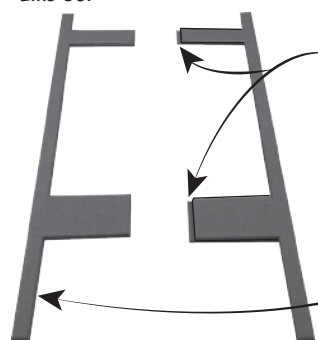
Before you start adding finishing touches and signs build up the corner store building.

## Fig. 12. CORNER STORE STRENGTHENERS

First off take corner strengtheners 2 & 3 (see fig.4) and fold them in half and glue.



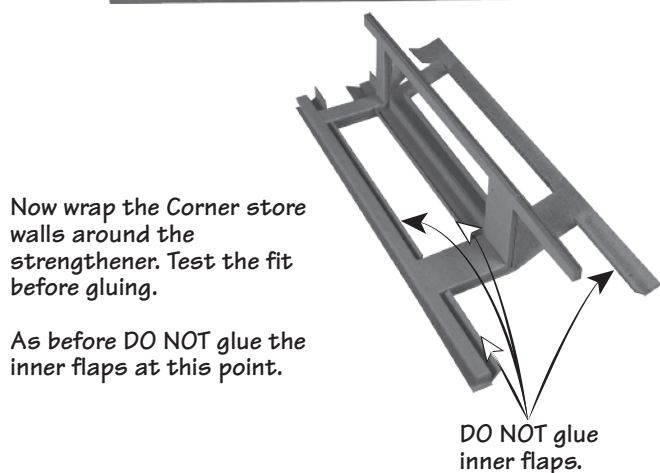
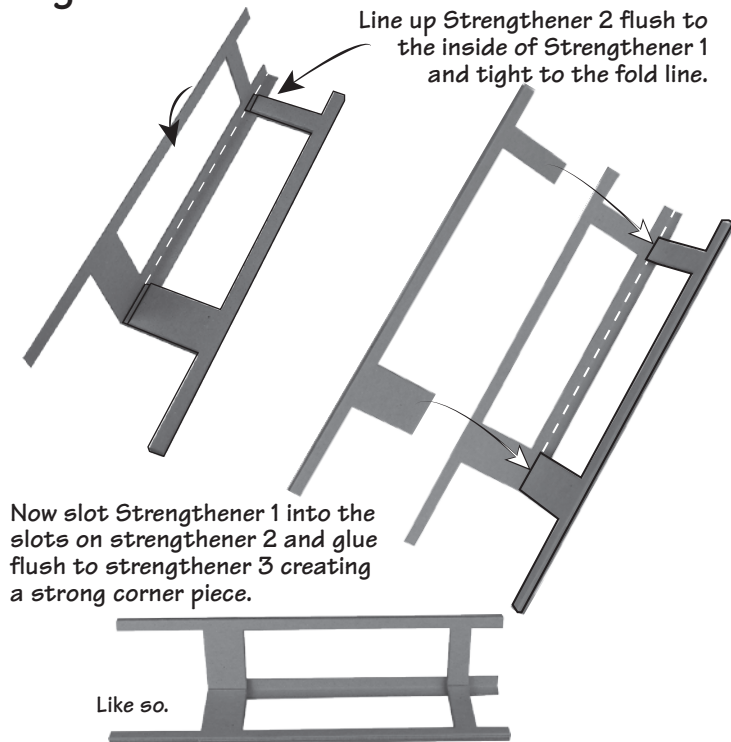
Like so.



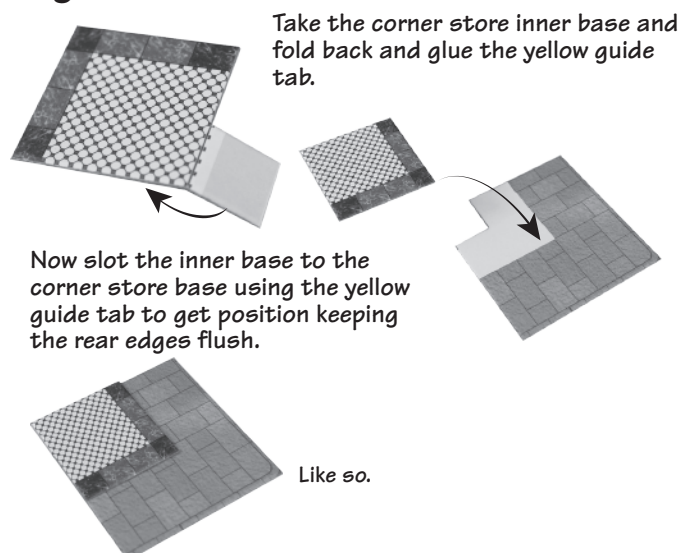
Strengtheners 2 has two tabs that are shorter on one side.

Straightener 3 is flush all around.

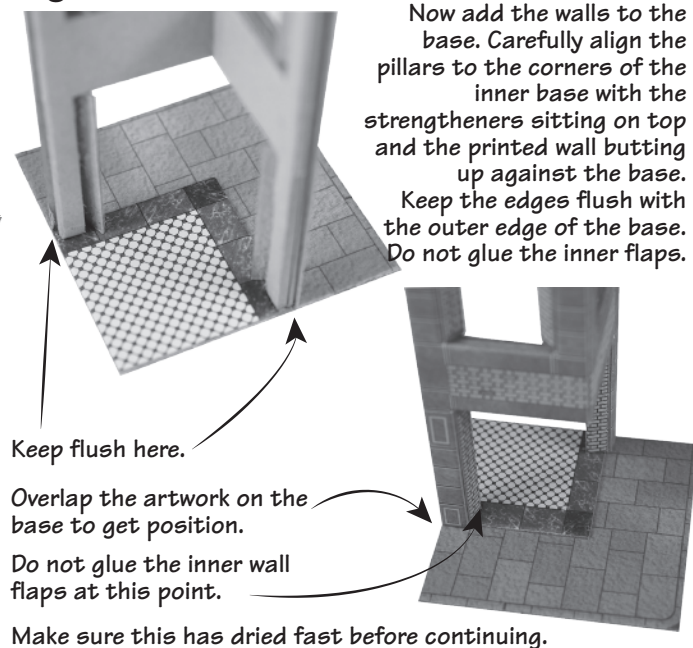
### Fig. 13. CORNER STORE STRENGTHENERS



### Fig. 14. CORNER STORE BASE



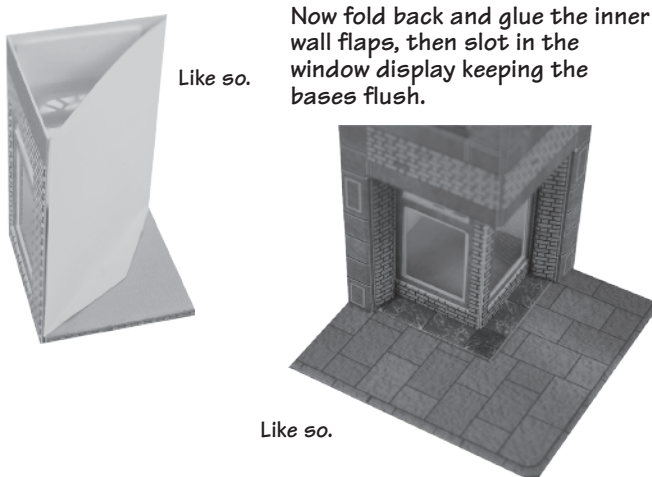
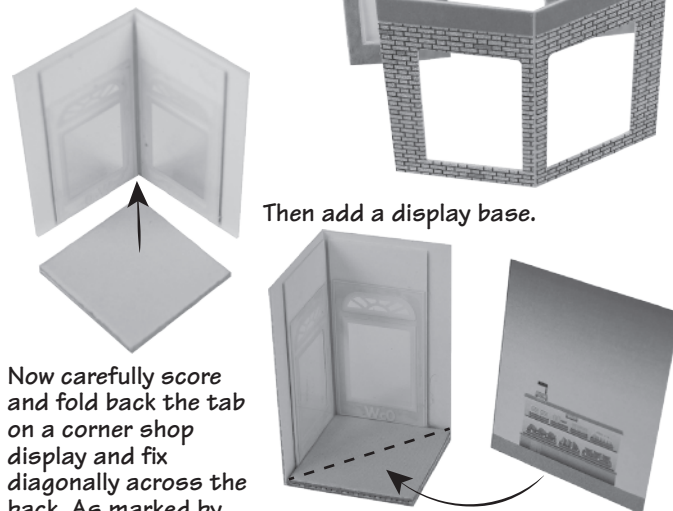
### Fig. 15. ATTACHING TO THE BASE



### Fig. 16. CORNER DISPLAY/DOOR OPTIONS

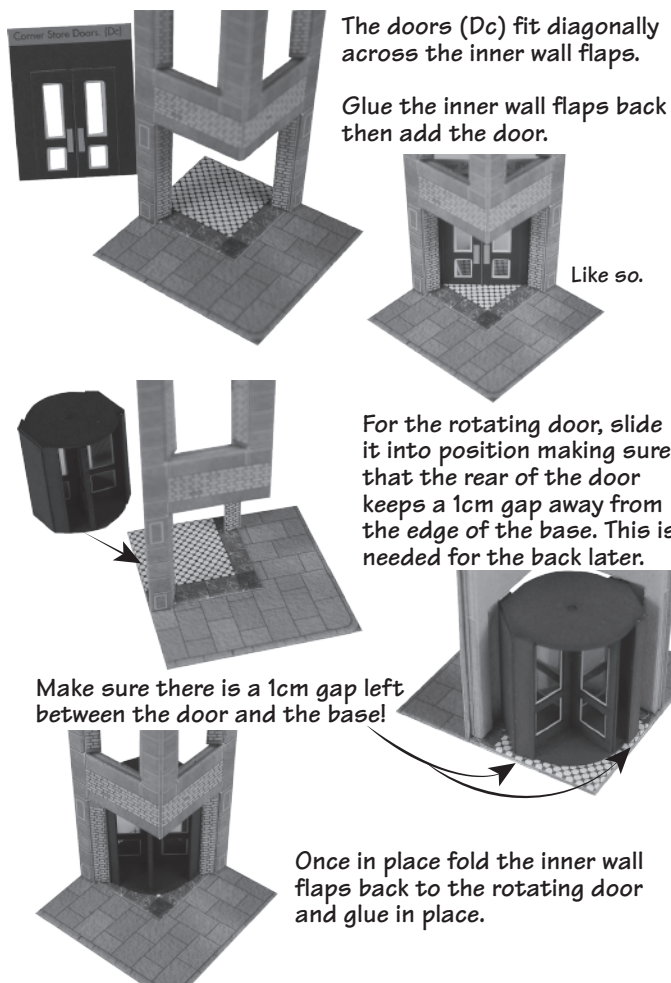
For the window display.

Carefully align and glue into position the 2 inner windows Wc0 to the outer window frame.

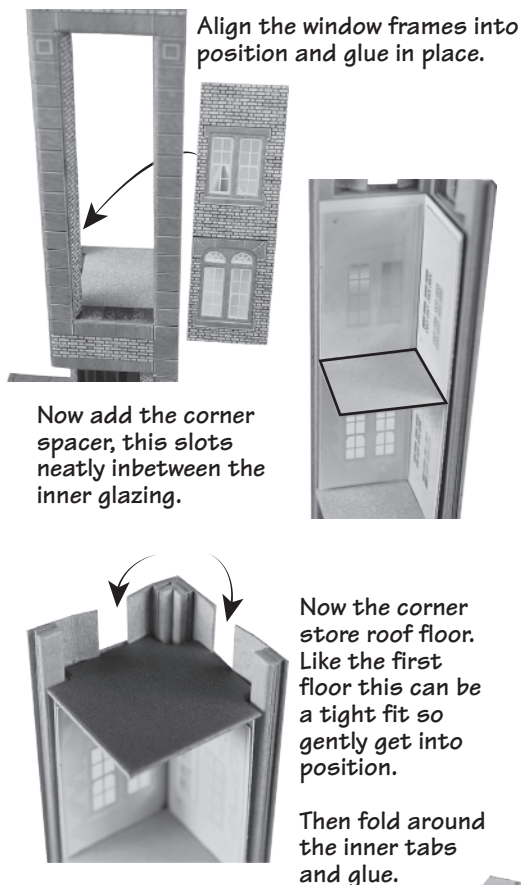




**Fig. 16. CORNER DISPLAY/DOOR**



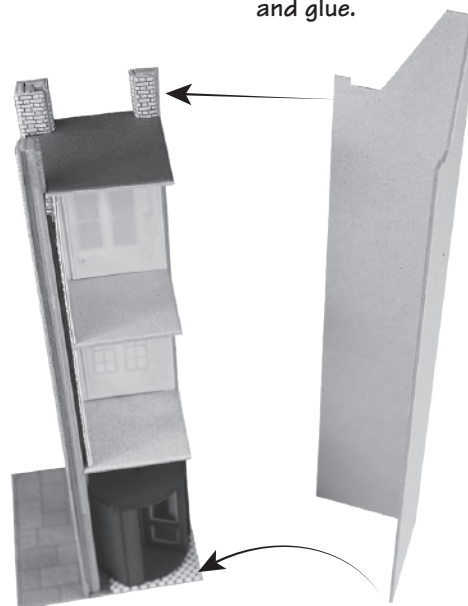
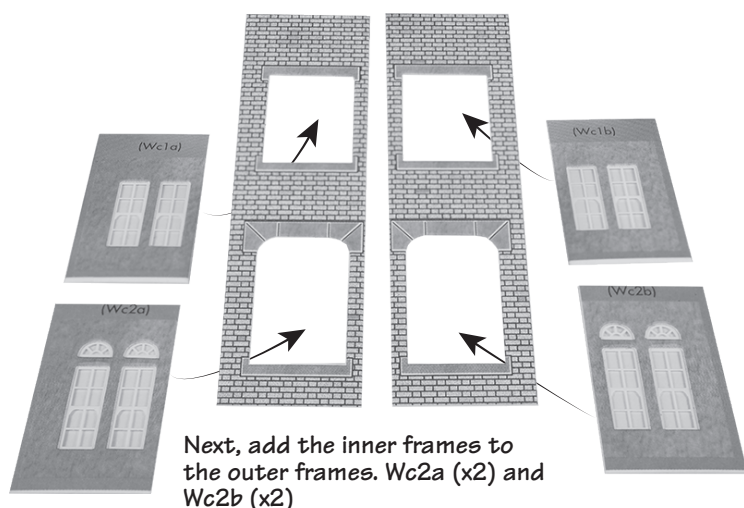
**Fig. 17. UPPER FLOORS cont.**



**Fig. 17. UPPER FLOORS**

As with the main building, first add the Corner store 1st floor. This is a snug fit so test the position first.

Then fold back the inner flaps and glue into place.





# PO279 OO Scale Low Relief DEPARTMENT STORE

## INSTRUCTION SHEET 3

Fig. 18. LASER CUT DETAILS

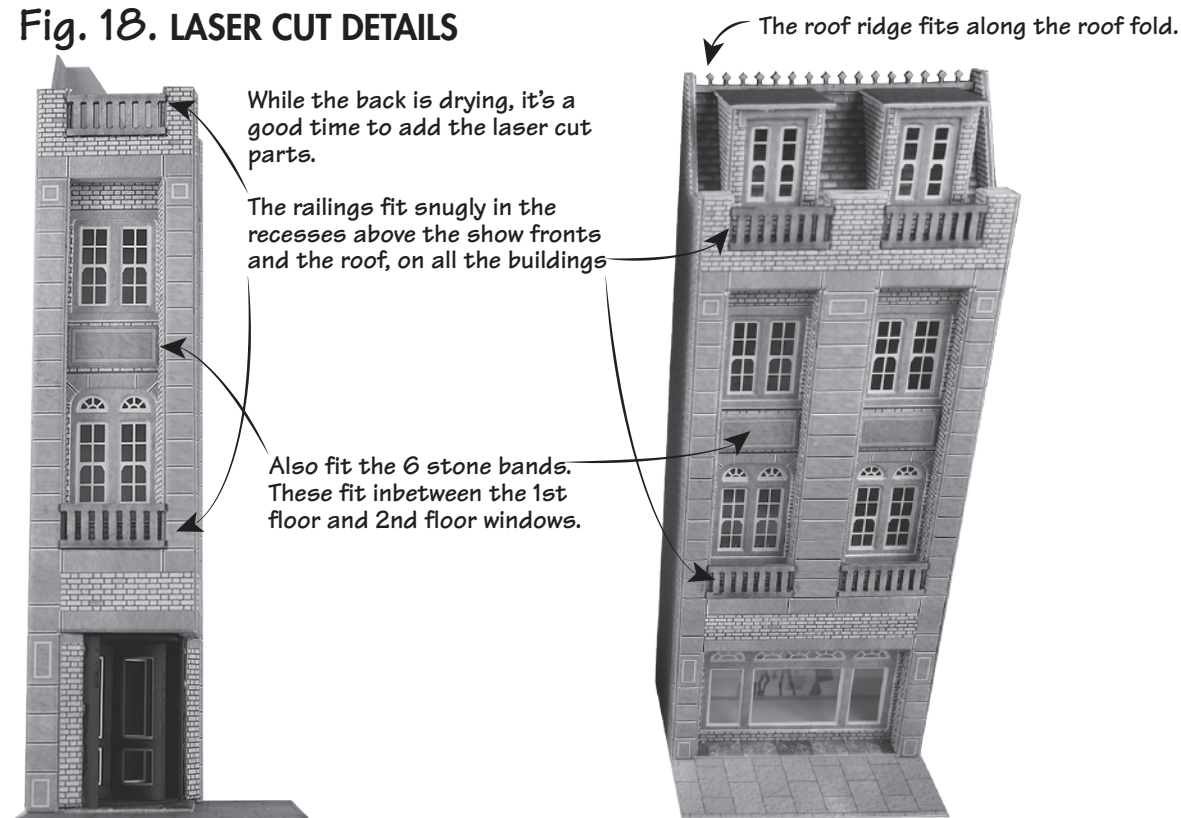
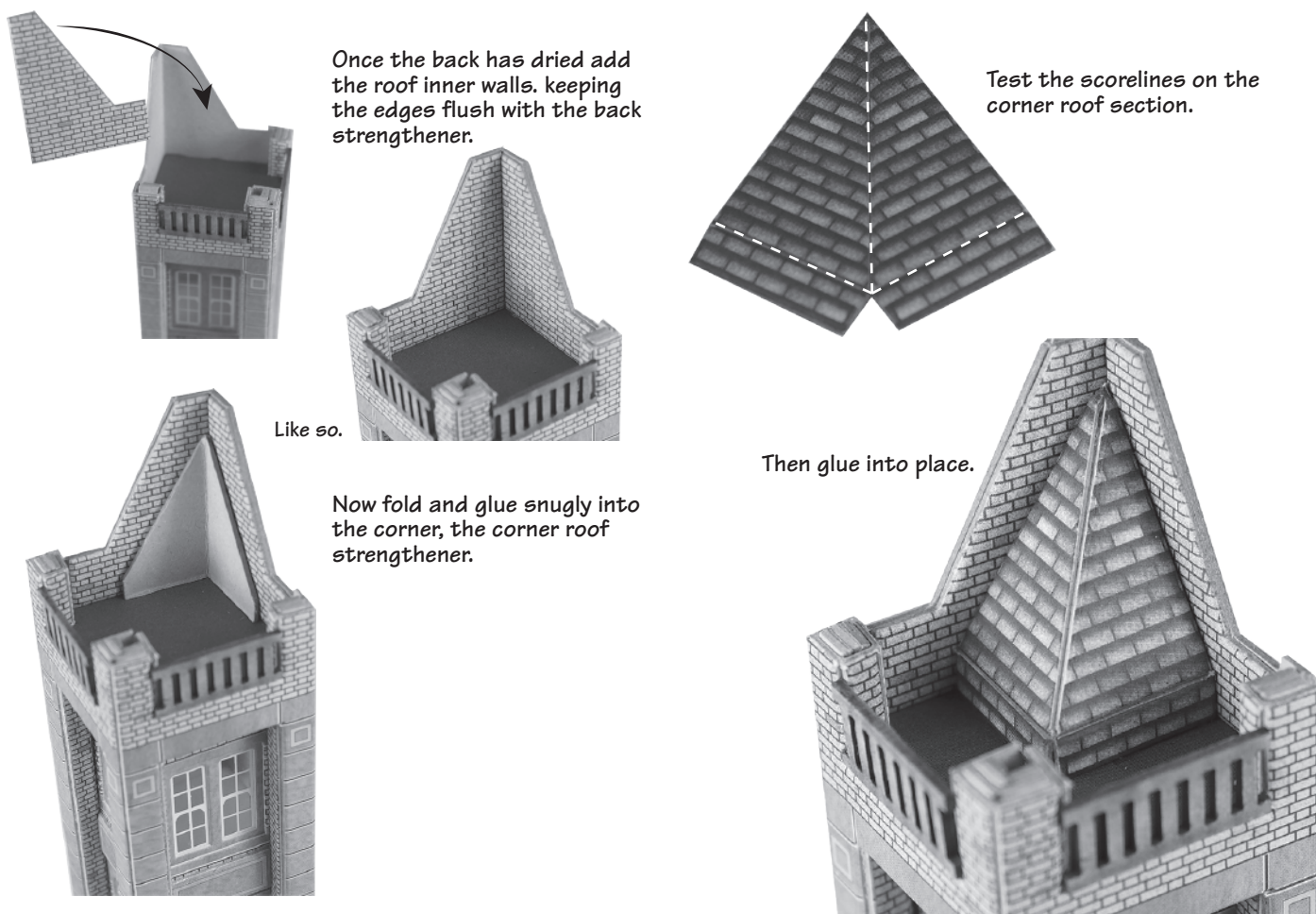
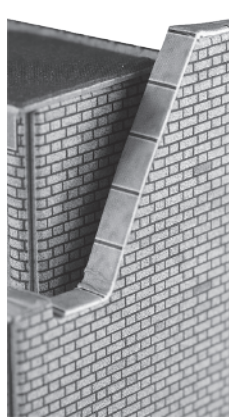


Fig. 19. CORNER STORE ROOF

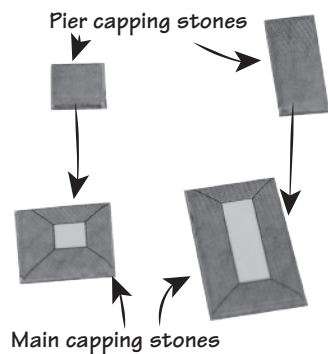
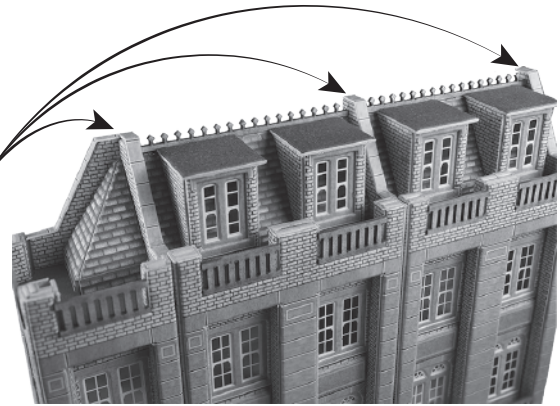


**Fig. 20. ROOF CAPPING**

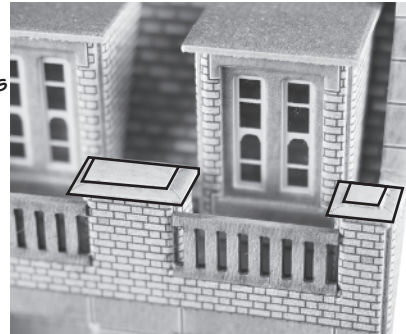


Now glue the buildings together in the required configuration.

Carefully bend a capping strip and glue into position along the top of the exposed walls.



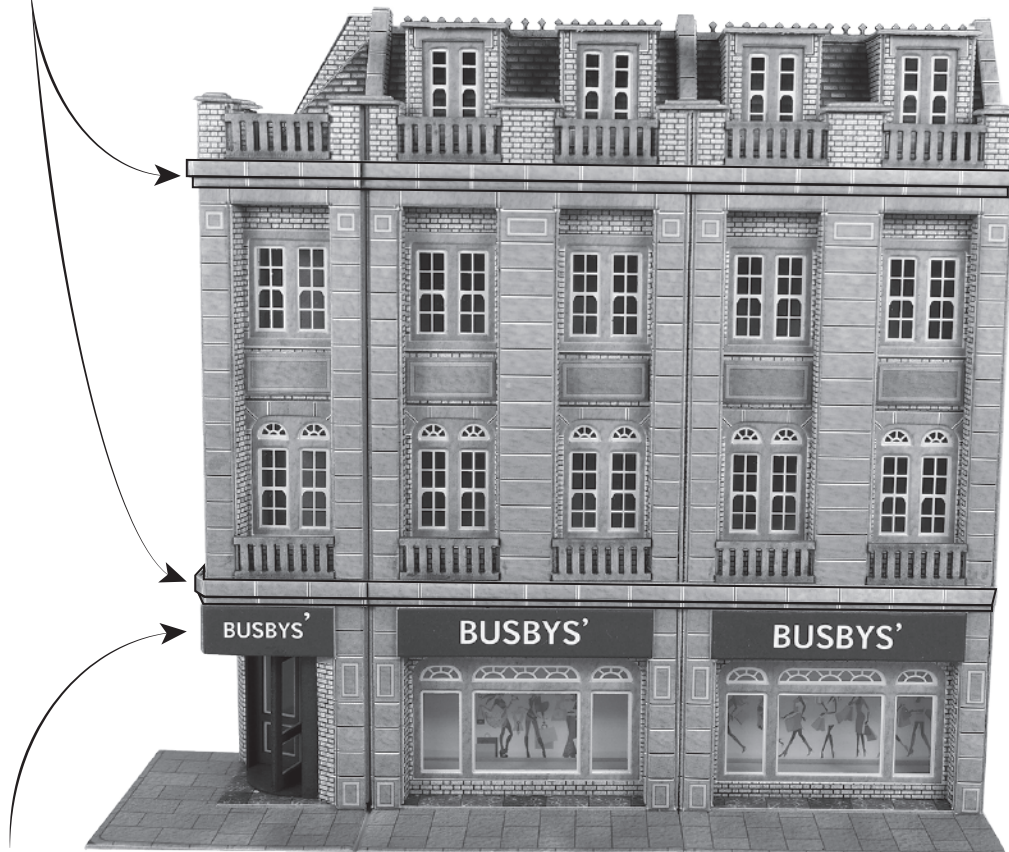
Then glue the pier capping stones to the main capping stones and fix to the roof wall sections.



Like so.

**Fig. 21. FINISHING TOUCHES**

To fit the stone strings, first affix the wide string flush against the base of the laser cut railings. Then the narrow stone string, again flush to the top of the underlying wide string.



Lastly add the signage of your choice, fixing them flush to the base of the stone string.