

PN174/5 N Scale Low Relief TERRACE HOUSE FRONTS

READ THROUGH ALL THE INSTRUCTIONS BEFORE YOU START.

To construct this kit you will need the following:

1. A Modellers knife.
2. A pair of sharp pointed scissors.
3. A steel ruler.
4. Glue - UHU Clear Adhesive is our favourite.
5. Ultra Fine Tip Glue Applicator, *see right*.
6. A cutting surface - a sheet of card or a cutting mat.
7. Fine point tweezers to hold the smaller components.
8. Water colour paints and a very fine brush, for painting the edges and corners.

GETTING STARTED

1 EXTRACTING COMPONENTS FROM SHEETS.

To stop the components from falling off the sheets, they are held secure with scorelines. These are cuts that only go about 75% of the way through the card.

To release them simply run the point of your knife along the scorelines and they will come seamlessly away.

These scorelines are indicated with blue arrows:

WARNING, Cut with care using a knife that is not too sharp, this will reduce the risk of the blade running out of the score and cutting the kit components.

2 MAKE YOUR 'BUILDERS YARD'.

This is an area kept away from your working surface, where you store ALL components extracted from the base sheets until needed.

Use a piece of thick card or a tray to make your builders yard.

Cut out all the components from sheet A & the grey strengthener sheet and place inside your builders yard.

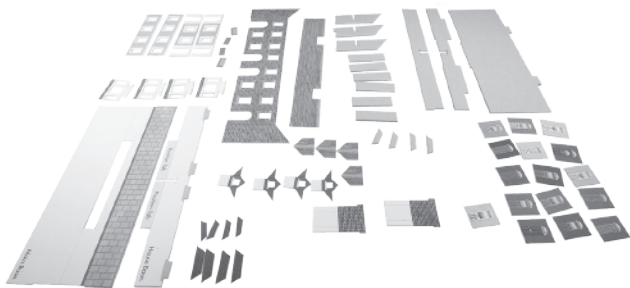

Now cut out the windows from the glazing sheet. Carefully cut along the outer white printed lines and place them onto a separate piece of card or small plate until needed.

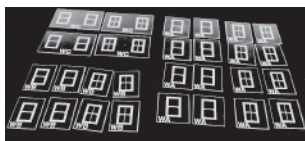

Your **WORKING** area should have a clean flat surface, and should only contain the kit parts you are actually working on.

EVERYTHING ELSE SHOULD BE KEPT NEATLY ARRANGED IN THE BUILDERS YARD, UNTIL NEEDED.

PLEASE NOTE: Don't throw anything away. Keep all and waste card in a box until the kit is finished, just in case you can't find anything. The chances are that it will be there.

INSTRUCTION SHEET 1

CHECK LIST

This kit pack should contain the following:

- 1 x SHEET A - Printed House Components
- 1 x Extras Sheet - Curtains and Chimney Pots
- 1 x PLAIN GREY CARD - Interior strengthening parts.
- 1 x INSTRUCTION SHEET.
- 1 x Glazing sheet.

The METCALFE Ultra Fine Tip Glue Bottles are essential for gluing the smaller components in this kit.



Tiny strips or spots of glue can be accurately laid down with precision.



Always replace the pin after use and store the bottles upside down to keep the glue moist.

UHU All Purpose Adhesive Glue

Is available in standard and solvent free. Both types are fine for use in our glue bottles, even though the instructions on the back of the packs warn against solvent based glues, we have tested the UHU solvent based glue and it works fine. The solvent free glue doesn't string as much, but can be a little harder to clean off if it drips onto unwanted areas.

Speed Bond by Deluxe Materials

This is an excellent PVA. based glue that dries quickly, but also allows time to get parts into position. It has the added advantage that it dries clear leaving little evidence if it oozes out of joints etc. Used in our fine glue applicator bottles a 112g bottle lasts for ages. www.deluxematerials.com

Fig. 1. WINDOWS

Start off by matching the windows to the inner window frames.

The single windows code WA are the ground floor windows that match up with the inner door and window frames. Carefully align and glue into place both the 2 windows (WA) and the 2 doors.

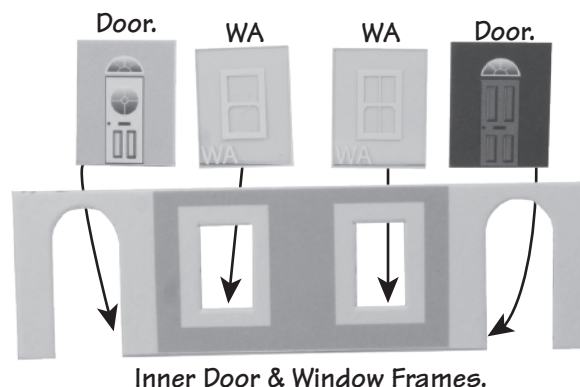

NOTE: The matt printed side of the glazing is the side that looks best facing through the window openings. Glue the glazing and doors to the NON-PRINTED side.

Fig. 1. WINDOWS CONTINUED

Now add the windows WB and WC to the 1st floor window frames. Make sure that the smaller window is to the outer (smaller) window frame.

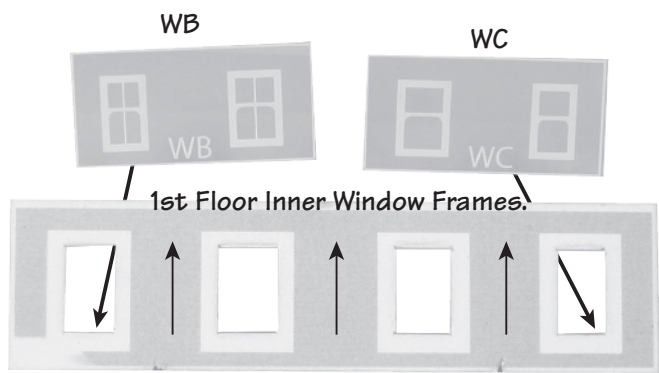

Make sure to have the inner frame the correct way around, The arrows point to the top of the frame. If you want to add curtains do this now. See Fig. 2

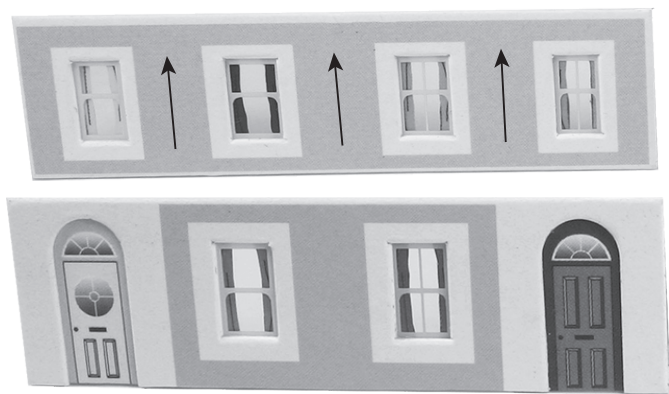

Now put aside the completed inner frames and move onto the House base.

Fig. 2. CURTAINS

Before you progress onto the main building, if you require curtains, now is the time to fit them.

To fit curtains fix a small strip of waste card to each side of the window, then glue the curtain to the waste card so that it shows through the window (the waste card will space the curtain back from the window a little giving a greater effect of depth).

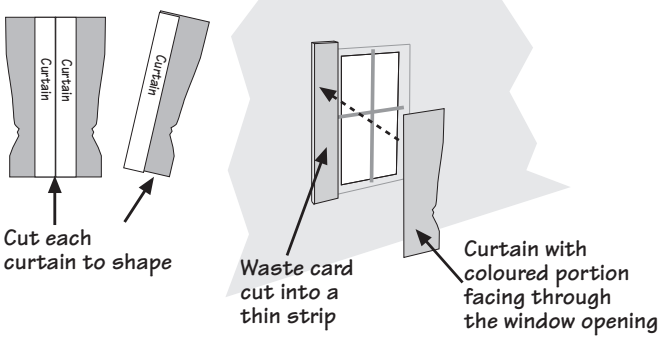

Bay Window Backs see fig.8



Fig. 3. STRENGTHENERS

Included in this kit is a plain grey card which contains strengthening parts. The diagram below assigns a description to each strengthener.

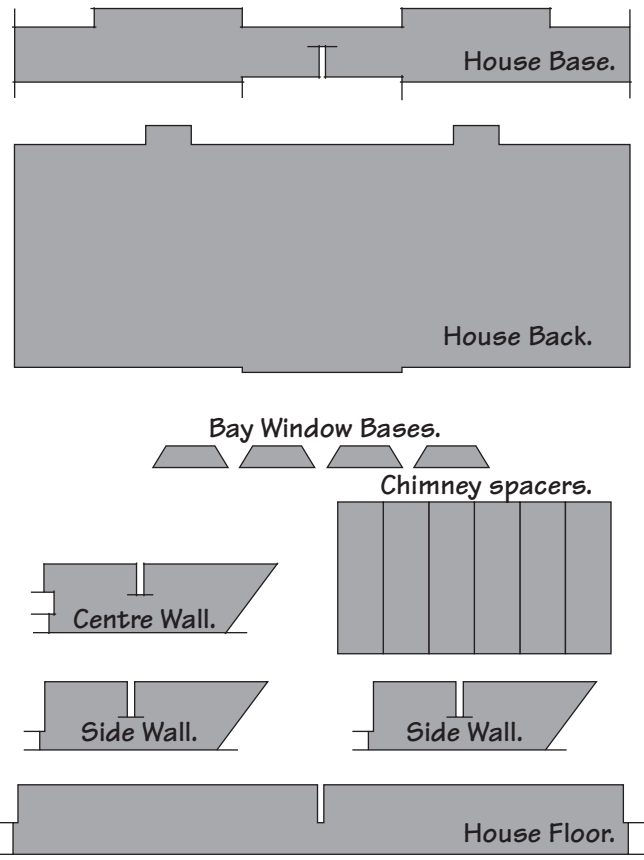

Fig. 4. HOUSE BASE

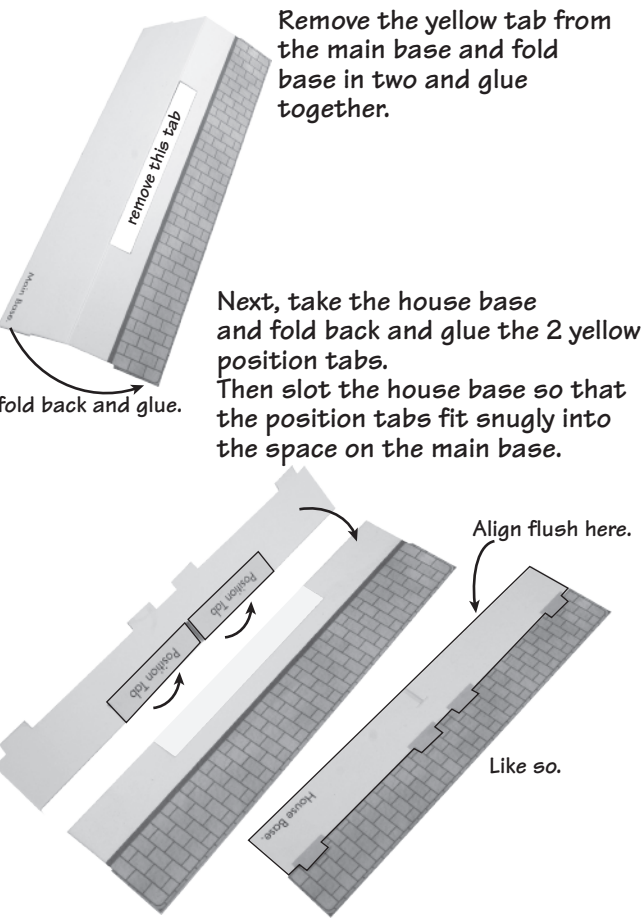

Fig. 4. HOUSE BASE continued

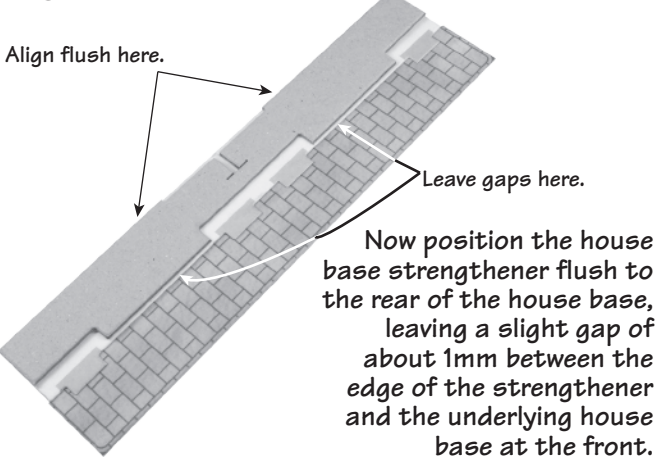
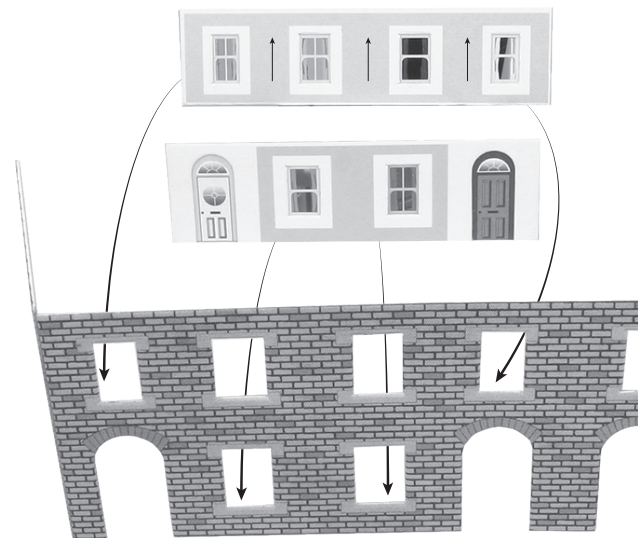

Fig. 5. HOUSE WALLS

Now retrieve the inner window and door frames from your builders yard. Carefully align the windows to the corresponding window frames on the house front and glue all 4 inner frames into position.



Now you need to fix the complete main house wall to the base. Test this fit before applying the glue!

The whole wall fits snugly against the strengthener on the base, with the end wall 'wings' folding around and flush against the side of the base. The doors fitting snugly over the doorsteps on the house base.

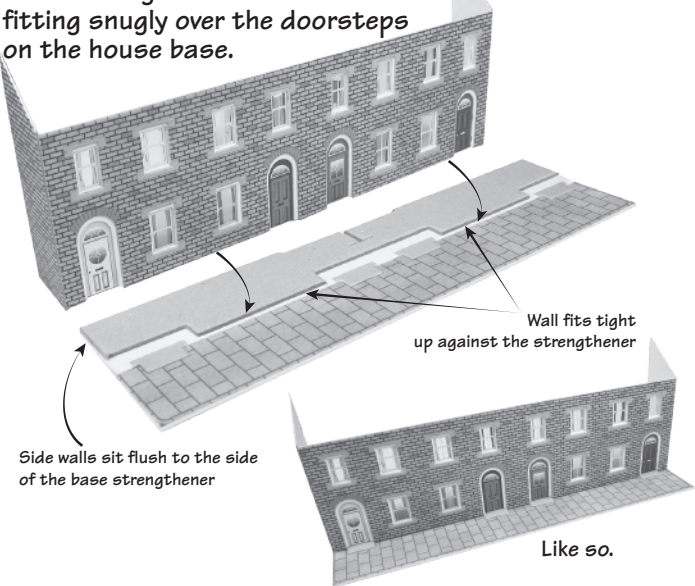

Fig. 6. HOUSE STRENGTHENERS

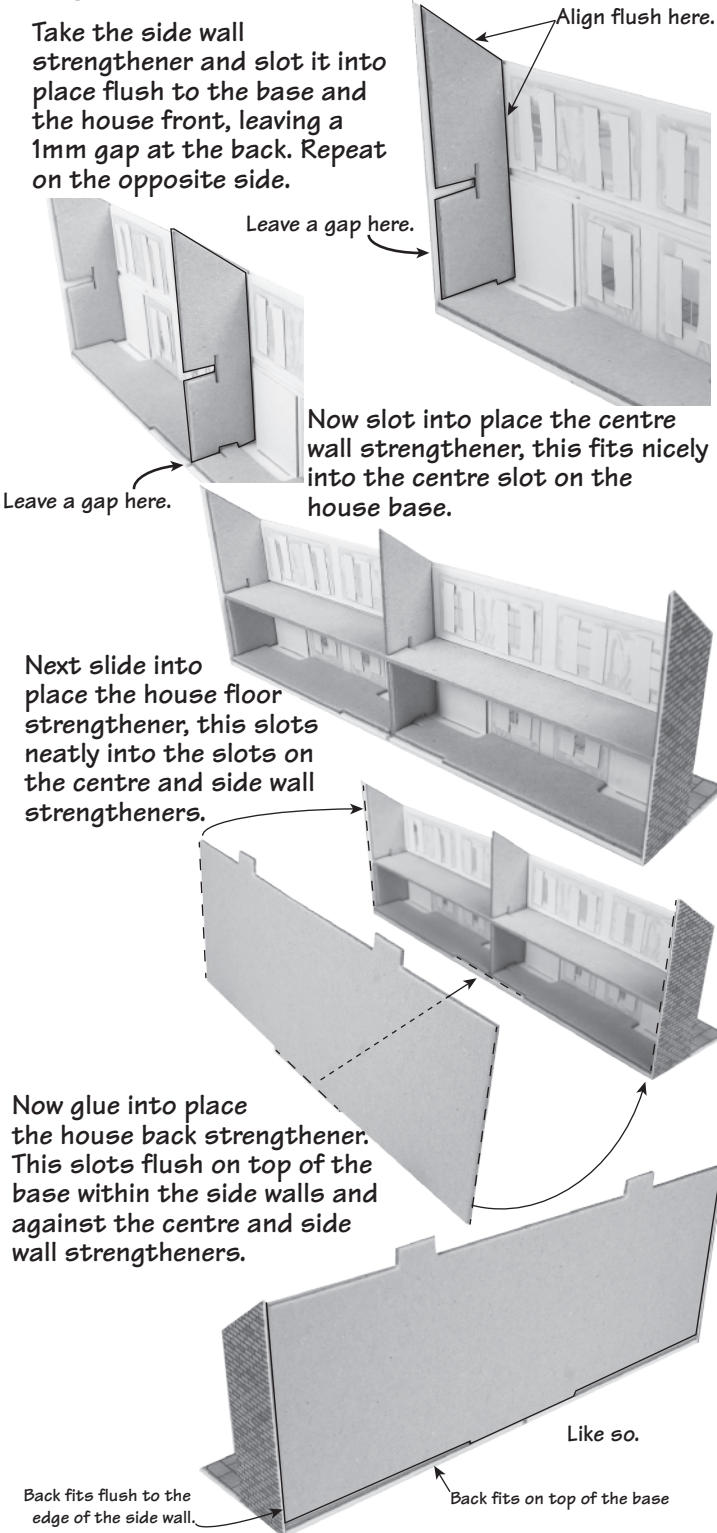

Fig. 7. CHIMNEY POTS

Cut into strips the chimney pots on sheet c, then roll tightly around a nail or screw (apx. 2mm dia.) and fix the end with a tiny spot of glue.

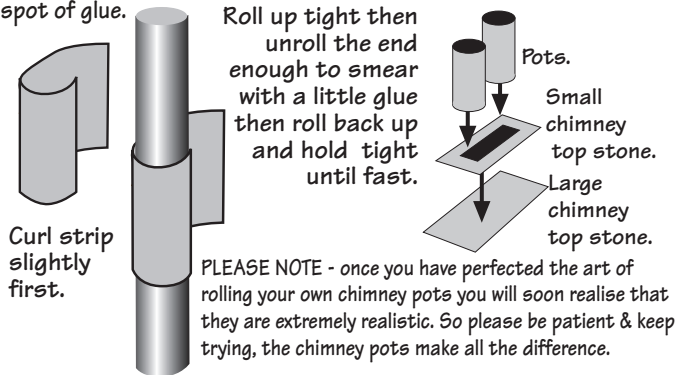
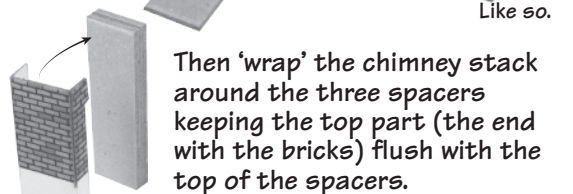
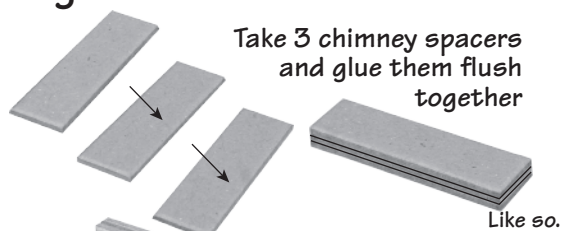
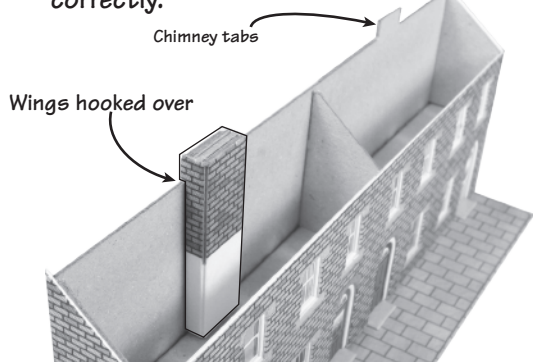

Fig. 8. CHIMNEYS



Then glue the completed stacks to the house back chimney tab. The chimney stack has 'short wings' that will hang onto the back to position it correctly.



Now slide the roof section into place lining the rear edge flush to the house back and the chimneys.



Now glue into place the larger chimney capping stone, keep the pale grey area flush to the house back.

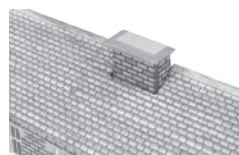

Then add the smaller capping stone, flush to the back with an even space to the front and sides.

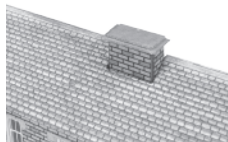
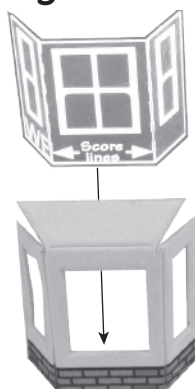

Fig. 9. BAY WINDOWS



Gently score the bay window glazing (WE) along the dotted line

Fold the bay window top tab down and flush to the side walls to create the correct shape and glue into place.

Then slide in the glazing and align to the window frame.

Fig. 9. BAY WINDOWS continued

Fix the bay window base strengthener flush to the bottom of the bay window.

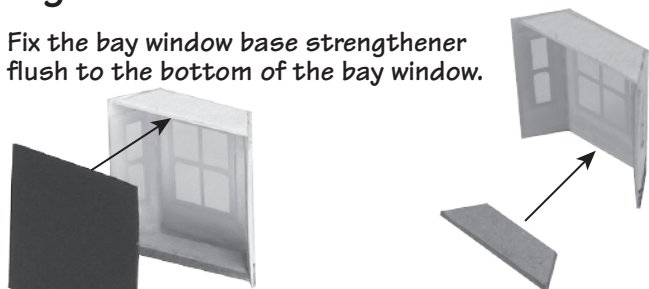

Cut out the 19mm by 19mm black bay window backs from Fig. 2 then glue it to the rear of the windows.

Now glue the smaller bay window roof onto the larger bay roof keeping the long edge (rear) flush, then affix to the bay window.

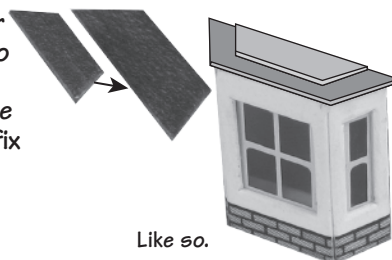
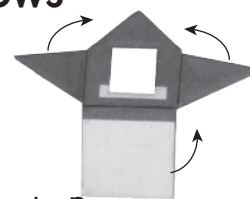
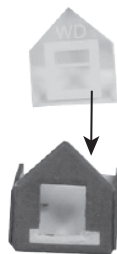

Fig. 10. DORMER WINDOWS

Fold back the base then dormer window side 'wings' and glue them to the folded back base.



Then slide into position the Dormer window glazing (WD) and glue into place.



Then paint the base facing through the window black.

Then glue the window to the roof, lining up the point level with the top of the roof ridge line.

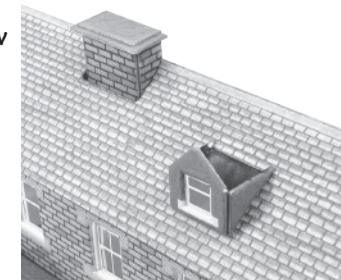
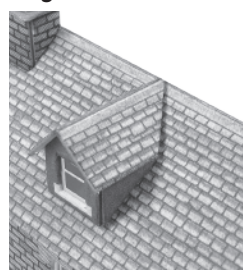

Finally add the roof section to the dormer.

Fig. 11. FINISHING TOUCHES

Fix the bay windows and dormers and cut sections of ridge tiles for the roof edges. Then add chimney pots.

